

PLANTING NOTES

- LANDSCAPE CONTRACTOR SHALL VISIT SITE PRIOR TO SUBMITTING BID TO BECOME COMPLETELY FAMILIAR WITH SITE CONDITIONS.
- NO PLANTING WILL BE INSTALLED UNTIL ALL GRADING AND CONSTRUCTION HAS BEEN COMPLETED IN THE IMMEDIATE AREA.
- CONTRACTOR TO VERIFY ALL UTILITIES ON PROPERTY AND TO PROTECT ALL UTILITIES DURING EXCAVATION.
- IF THERE IS A DISCREPANCY BETWEEN THE NUMBER OF PLANTS SHOWN ON THE PLAN AND THE NUMBER OF PLANTS SHOWN IN THE PLANT LIST, THE NUMBER OF PLANTS SHOWN ON THE LIST WILL TAKE PRECEDENCE.
- ALL CONTAINER MATERIAL TO BE GROWN IN CONTAINER A MINIMUM OF SIX MONTHS.
- ALL MATERIAL SHALL COMPLY WITH THE LATEST EDITION OF THE AMERICAN STANDARD FOR NURSERY STOCK, ACCORDING TO THE AMERICAN ASSOCIATION OF NURSERYMEN.
- CONTRACTOR SHALL REPAIR ALL DAMAGE TO PROPERTY FROM PLANTING OPERATIONS AT NO COST TO THE OWNER.
- CONTRACTOR SHALL GUARANTEE NEW PLANT MATERIAL THROUGH ONE CALENDAR YEAR FROM TIME OF PROVISIONAL ACCEPTANCE.
- ALL PROPOSED PLANTS SHALL BE LOCATED CAREFULLY AS SHOWN ON THE PLANS AND THE PLACEMENT SHALL BE APPROVED BY THE LANDSCAPE ARCHITECT BEFORE THE INSTALLATION.
- ALL DISTURBED AREAS NOT TO BE PAVED OR PLANTED SHALL BE LOAMED AND SEEDED AS SHOWN. SEE SPECIFICATIONS FOR SOIL PREPARATION AND SEED MIX.
- TWO INCH (2") DEEP FINELY SHREDDED BARK MULCH WILL BE INSTALLED AROUND ALL TREES AND SHRUBS THAT ARE ISOLATED FROM GROUND COVER AREAS AND GENERAL SHRUB MASSES.
- ALL PLANT MATERIAL SHALL BE INSPECTED BY THE LANDSCAPE ARCHITECT ON SITE PRIOR TO INSTALLATION. THE LANDSCAPE ARCHITECT WILL TAG ALL TREES AT THE NURSERY AND INSPECT THEM AFTER DELIVERY TO THE SITE. SEE SPECIFICATIONS FOR TAGGING, INSPECTION, AND ACCEPTANCE OF PLANT MATERIAL.
- LANDSCAPE ARCHITECT SHALL CONFIRM PLANT LIST AND APPROVE SUBSTITUTIONS OF PLANT VARIETIES PRIOR TO ORDERING OF MATERIAL.
- SOIL MIX: 1/3 PEAT MOSS, 1/3 SCREENED LOAM, 1/3 DEHYDRATED MANURE.
- THE OWNER RESERVES THE RIGHT TO SUBSTITUTE PLANT SELECTIONS WITH PLANTS OF SIMILAR CHARACTERISTICS IF THE SPECIFIED PLANTS ARE NOT AVAILABLE IN ACCEPTABLE QUANTITIES OR CONDITIONS.

PLANT LIST

SYMBOL	BOTANICAL NAME	COMMON NAME	QTY	SIZE
DECIDUOUS TREES				
ACE RUB	ACER RUBRUM	RED MAPLE	4	4" CAL
ACE OCT	ACER RUBRUM 'OCTOBER GLORY'	OCTOBER GLORY RED MAPLE	9	4" CAL
ACE FRE	ACER X FREEMANNI 'JEFFERSRED'	AUTUMN BLAZE MAPLE - CLUMP	1	8/10" B&B
AME ALN	AMELANCHIER 'AUTUMN BRILLIANCE'	AUTUMN BRILLIANCE SHADBLOW	2	8/10" CLUMP
BET PLA	BETULA PLATYPHYLLA 'PARKLAND PILLAR'	PARKLAND PILLAR ASIAN WHITE BIRCH	10	4" MIX CAL
QUE PAL	QUERCUS PALustris	PIN OAK	2	4" CAL
NYS SYL	NYSSA SYLVATICA	BLACK TUPELO	3	3" CAL
EVERGREEN TREES				
CRY JAP	CRYPTOMERIA JAPONICA	JAPANESE CEDAR	6	8/10" B&B
JUN HET	JUNIPERUS CHINENSIS 'HETZI COLUMNARIS'	HETZI COLUMNAR JUNIPER	12	5/8" B&B
THU PLI	THUJA PLICATA 'GREEN GIANT'	GREEN GIANT ARBORVITAE	9	8/10" B&B
SHRUBS				
CLE ALN	CLETHRA ALNIFOLIA 'HUMMINGBIRD'	HUMMINGBIRD SUMMERSWEET	8	5 GAL. CONT.
COR ALB	CORNUS ALBA 'TWOY HALO'	VARIEGATED DOGWOOD	25	5 GAL. CONT.
ILE GLA	ILEX GLABRA 'SHAMROCK'	INKBERRY	125	5 GAL. CONT.
ILE VER	ILEX VERTICILLATA 'RED SPRITE'	WINTERBERRY	12	7 GAL. CONT.
MYR PEN	MYRTICA PENNSYLVANICA	BAYBERRY	12	7 GAL. CONT.
VIB DEN	VIBURNUM DENTATUM 'BLUE MUFFIN'	ARROWWOOD VIBURNUM	30	5 GAL. CONT.
PERENNIALS				
EUP DUB	EUPATORIUM DUBIUM 'LITTLE JOE'	JOE PYE WEED	17	1 GAL. CONT.
HEM VAR	HEMEROCALLIS VAR.	DAYLILY	336	1 GAL. CONT.
PER ATR	PEROVSKIA ATR 'LITTLE SPRIE'	RUSSIAN SAGE	14	1 GAL. CONT.
RUD FUL	RUDBECKIA FULGIDA V. FULGIDA	CONEFLOWER	19	1 GAL. CONT.
SAL CAR	SALVIA CARONNA	MEADOW SAGE - PURPLE	65	1 GAL. CONT.
GRASSES				
CAL KAR	CALAMAGROSTIS 'KARL FOERSTER'	FEATHER REED GRASS	266	1 GAL. CONT.
SES ALU	SESALIA AUTUMNALIS	AUTUMN MOOR GRASS	384	1 GAL. CONT.
PEN HAM	PENNISETUM A 'HAMELN'	DWARF FOUNTAIN GRASS	30	1 GAL. CONT.
PAN VIR	PANICUM VIRGATUM 'SHENANDOAH'	SHENANDOAH SWITCH GRASS	218	1 GAL. CONT.
SPO HET	SPOROBOLUS HETEROLEPIS	PRAIRIE DROPSIDE	315	1 GAL. CONT.
SCH SCO	SCHIZACHYRIUM SCOPARIUM 'CAROUSEL'	CAROUSEL LITTLE BLUESTEM	35	2 GAL. CONT.
GROUND COVER				
LITTLE BLUESTEM MEADOW			10,251 SF	
100% LITTLE BLUESTEM				
LOW MOWING MOW MIX			12,798 SF	
25% CREEPING RED FESCUE				
25% SHEEPS FESCUE				
25% HARD FESCUE				
25% CHEWINGS FESCUE				
NATIVE SEED MIX			3,207 SF	
30% HARD FESCUE				
25% PER. RYE				
25% LITTLE BLUESTEM				
20% SWITCHGRASS				

FOR SEED, CONTACT ALLEN SEED
GENERAL INFO: INFO@ALLENSSEED.COM

AL LAPRISE
CT & RI SALES
401-741-4444
AL.LAPRISE@ALLENSSEED.COM

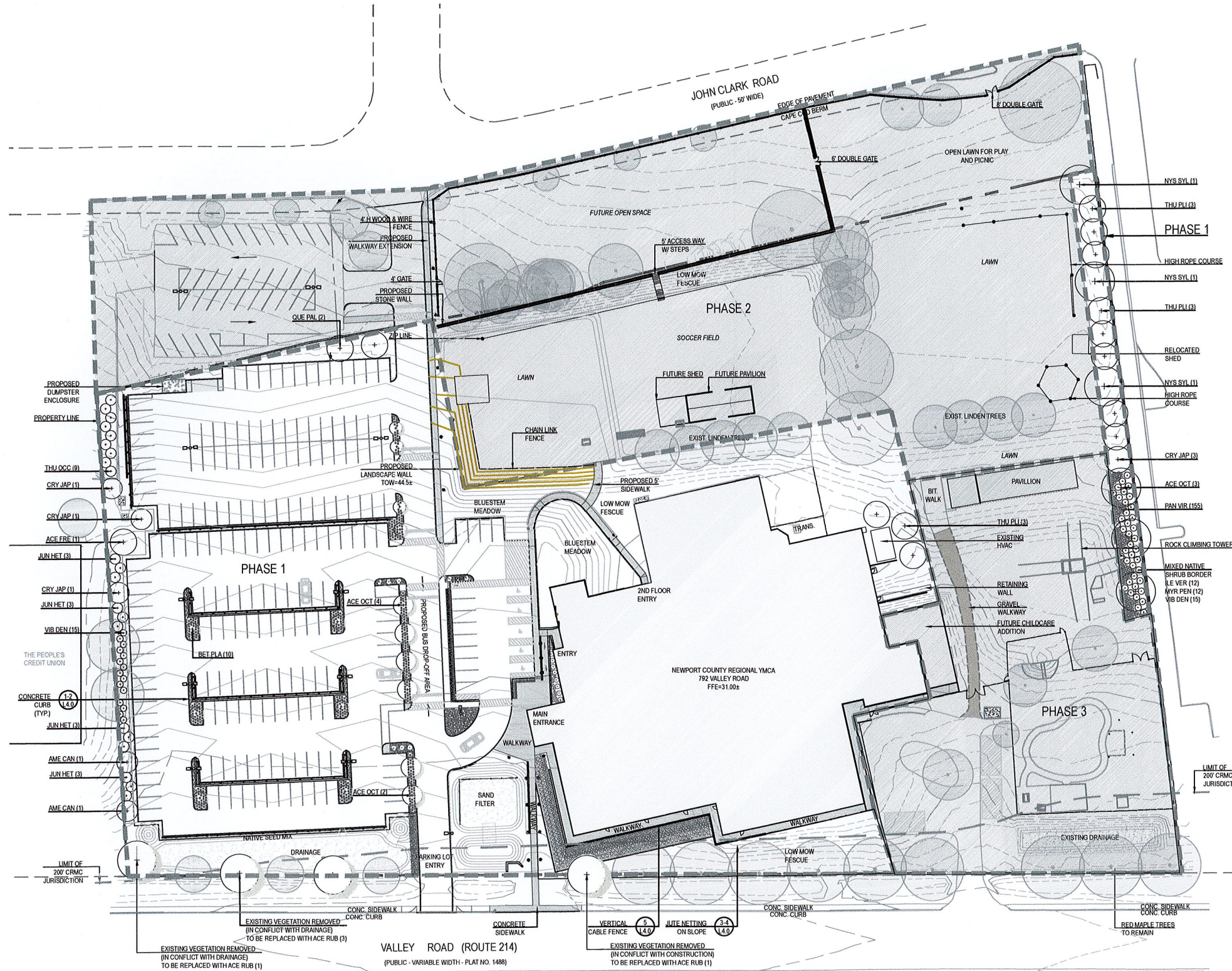

VERDE DESIGN + HORTICULTURE
89 DR MARCUS WHEATLAND BLVD
NEWPORT RI 02840
O. 401 619-0562
verdegardens@gmail.com

CIVIL ENGINEER
LDEC
1700 WEST MAIN ROAD
MIDDLETOWN RI
401 354 2050

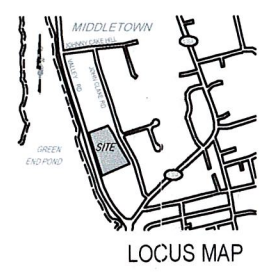

YMCA
792 VALLEY ROAD
MIDDLETOWN, RI



PROJECT NUMBER: 19.028
DRAWN BY: KD
CHECKED BY: PR
SCALE: 1"=40'-0"
DATE: 03.28.2023

REVISIONS:

NO.	DESCRIPTION

LANDSCAPE PLAN



L1.0

PLANTING NOTES

- LANDSCAPE CONTRACTOR SHALL VISIT SITE PRIOR TO SUBMITTING BID TO BECOME COMPLETELY FAMILIAR WITH SITE CONDITIONS.
- NO PLANTING WILL BE INSTALLED UNTIL ALL GRADING AND CONSTRUCTION HAS BEEN COMPLETED IN THE IMMEDIATE AREA.
- CONTRACTOR TO VERIFY ALL UTILITIES ON PROPERTY AND TO PROTECT ALL UTILITIES DURING EXCAVATION.
- IF THERE IS A DISCREPANCY BETWEEN THE NUMBER OF PLANTS SHOWN ON THE PLAN AND THE NUMBER OF PLANTS SHOWN IN THE PLANT LIST, THE NUMBER OF PLANTS SHOWN ON THE LIST WILL TAKE PRECEDENCE.
- ALL CONTAINER MATERIAL TO BE GROWN IN CONTAINER A MINIMUM OF SIX MONTHS.
- ALL MATERIAL SHALL COMPLY WITH THE LATEST EDITION OF THE AMERICAN STANDARD FOR NURSERY STOCK, ACCORDING TO THE AMERICAN ASSOCIATION OF NURSERYMEN.
- CONTRACTOR SHALL REPAIR ALL DAMAGE TO PROPERTY FROM PLANTING OPERATIONS AT NO COST TO THE OWNER.
- CONTRACTOR SHALL GUARANTEE NEW PLANT MATERIAL THROUGH ONE CALENDAR YEAR FROM TIME OF PROVISIONAL ACCEPTANCE.
- ALL PROPOSED PLANTS SHALL BE LOCATED CAREFULLY AS SHOWN ON THE PLANS AND THE PLACEMENT SHALL BE APPROVED BY THE LANDSCAPE ARCHITECT BEFORE THE INSTALLATION.
- ALL DISTURBED AREAS NOT TO BE PAVED OR PLANTED SHALL BE LOAMED AND SEEDED AS SHOWN. SEE SPECIFICATIONS FOR SOIL PREPARATION AND SEED MIX.
- TWO INCH (2") DEEP, FINELY SHREDDED BARK MULCH WILL BE INSTALLED AROUND ALL TREES AND SHRUBS THAT ARE ISOLATED FROM GROUND COVER AREAS AND GENERAL SHRUB MASSES.
- ALL PLANT MATERIAL SHALL BE INSPECTED BY THE LANDSCAPE ARCHITECT ON SITE PRIOR TO INSTALLATION. THE LANDSCAPE ARCHITECT WILL TAG ALL TREES AT THE NURSERY AND INSPECT THEM AFTER DELIVERY TO THE SITE. SEE SPECIFICATIONS FOR TAGGING, INSPECTION, AND ACCEPTANCE OF PLANT MATERIAL.
- LANDSCAPE ARCHITECT SHALL CONFIRM PLANT LIST AND APPROVE SUBSTITUTIONS OF PLANT VARIETIES PRIOR TO ORDERING OF MATERIAL.
- SOIL MIX: 1/3 PEAT MOSS, 1/3 SCREENED LOAM, 1/3 DEHYDRATED MANURE.
- THE OWNER RESERVES THE RIGHT TO SUBSTITUTE PLANT SELECTIONS WITH PLANTS OF SIMILAR CHARACTERISTICS IF THE SPECIFIED PLANTS ARE NOT AVAILABLE IN ACCEPTABLE QUANTITIES OR CONDITIONS.

PLANT LIST

SYMBOL	BOTANICAL NAME	COMMON NAME	QTY	SIZE
DECIDUOUS TREES				
ACE RUB	ACER RUBRUM	RED MAPLE	4	4" CAL.
ACE OCT	ACER RUBRUM 'OCTOBER GLORY'	OCTOBER GLORY RED MAPLE	9	4" CAL.
ACE FRE	ACER X FREEMANNI 'JEFFERSRED'	AUTUMN BLAZE MAPLE - CLUMP	1	8 1/2" B&B
AME ALN	AMELANCHIER 'AUTUMN BRILLIANCE'	AUTUMN BRILLIANCE SHADBLOW	2	8 1/2" CLUMP
BET PLA	BETULA PLATYPHYLLA 'PARKLAND PILLAR'	PARKLAND PILLAR ASIAN WHITE BIRCH	10	4" MIX CAL.
QUE PAL	QUERCUS PALUSTRIS	PIN OAK	2	4" CAL.
NYS SYL	NYSSA SYLVATICA	BLACK TUPELO	3	3" CAL.
EVERGREEN TREES				
CRY JAP	CRYPTOMERIA JAPONICA	JAPANESE CEDAR	6	8 1/2" B&B
JUN HET	JUNIPERUS CHINENSIS 'HETZLI COLUMNARIS'	HETZLI COLUMNAR JUNIPER	12	5 1/2" B&B
THU PLI	THUJA PLICATA 'GREEN GIANT'	GREEN GIANT ARBORVITAE	9	8 1/2" B&B
SHRUBS				
CLE ALN	CLETHRA ALNIFOLIA 'HUMMINGBIRD'	HUMMINGBIRD SUMMERSWEET	8	5 GAL. CONT.
COR ALB	CORNUS ALBA 'NIGRA'	VARIEGATED DOGWOOD	25	5 GAL. CONT.
ILE GLA	ILEX GLABRA 'SHAMROCK'	INKBERRY	125	5 GAL. CONT.
ILE VER	ILEX VERTICILLATA 'RED SPRITE'	WINTERBERRY	12	7 GAL. CONT.
MYR PEN	MYRICA PENNSYLVANICA	BAYBERRY	12	7 GAL. CONT.
VIB DEN	VIBURNUM DENTATUM 'BLUE MUFFIN'	ARROWWOOD VIBURNUM	30	5 GAL. CONT.
PERENNIALS				
EUP DUB	EUPATORIUM DUBIUM 'LITTLE JOE'	JOE PYE WEED	17	1 GAL. CONT.
HEM VAR	HEMEROCALLIS VAR.	DAY LILLY	336	1 GAL. CONT.
PER ATR	PEROVSKIA 'LITTLE SPIRE'	RUSSIAN SAGE	14	1 GAL. CONT.
RUD FUL	RUDBECKIA FULGIDA V. FULGIDA	CONEFLOWER	19	1 GAL. CONT.
SAL CAR	SALVIA CARONNA	MEADOW SAGE - PURPLE	65	1 GAL. CONT.
GRASSES				
CAL KAR	CALAMAGROSTIS 'KARL FOERSTER'	FEATHER REED GRASS	256	1 GAL. CONT.
SES AUT	SESALERIA AUTUMNALIS	AUTUMN MOOR GRASS	384	1 GAL. CONT.
PEN HAM	PENNISSETUM A 'HAMELIN'	DWARF FOUNTAIN GRASS	30	1 GAL. CONT.
PAN VIR	PANICUM VIRGATUM 'SHENANDOAH'	SHENANDOAH SWITCH GRASS	218	1 GAL. CONT.
SPO HET	SPOROBOLUS HETEROLEPIS	PRAIRIE DROPSEED	315	1 GAL. CONT.
SCH SCO	SCHIZACHYRIUM SCOPARIUM 'CAROUSEL'	CAROUSEL LITTLE BLUESTEM	35	2 GAL. CONT.
GROUND COVER				
LITTLE BLUESTEM MEADOW 100% LITTLE BLUESTEM			10,251 SF	
LOW MOWING MOW MIX 25% CREEPING RED FESCUE 25% SHEEPS FESCUE 25% HARD FESCUE 25% CHEWINGS FESCUE			12,798 SF	
NATIVE SEED MIX 30% HARD FESCUE 25% PER RYE 25% LITTLE BLUESTEM 20% SWITCHGRASS			3,207 SF	
FOR SEED, CONTACT ALLEN SEED GENERAL INFO: INFO@ALLENSSEED.COM				
AL LAPRISE CT & RI SALES 401-741-4444 AL.LAPRISE@ALLENSSEED.COM				

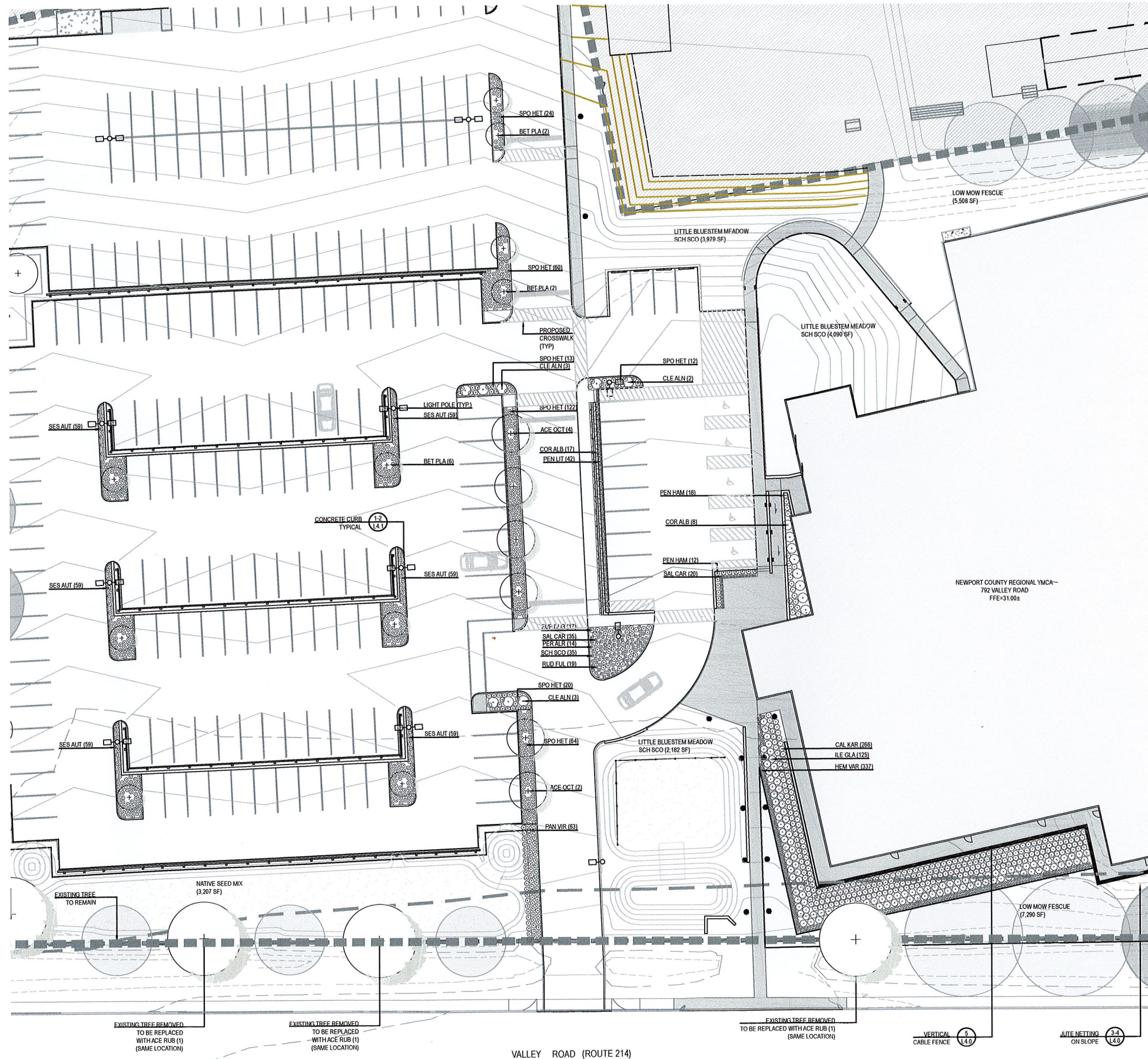

VERDE DESIGN + HORTICULTURE
89 DR MARCUS WHEATLAND BLVD
NEWPORT RI 02840
O. 401 619-0562
verdegardens@gmail.com

CIVIL ENGINEER
LDEC
1700 WEST MAIN ROAD
MIDDLETOWN RI
401 354 2050

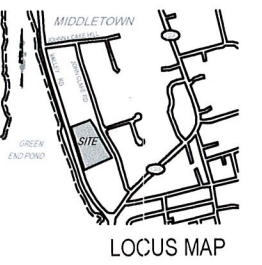

YMCA
792 VALLEY ROAD
MIDDLETOWN, RI



PROJECT NUMBER: 19 028
DRAWN BY: KD
CHECKED BY: PR
SCALE: 1"=20'-0"
DATE: 03-28-2023

REVISIONS:

NO.	DESCRIPTION

LANDSCAPE PLAN ENLARGEMENT

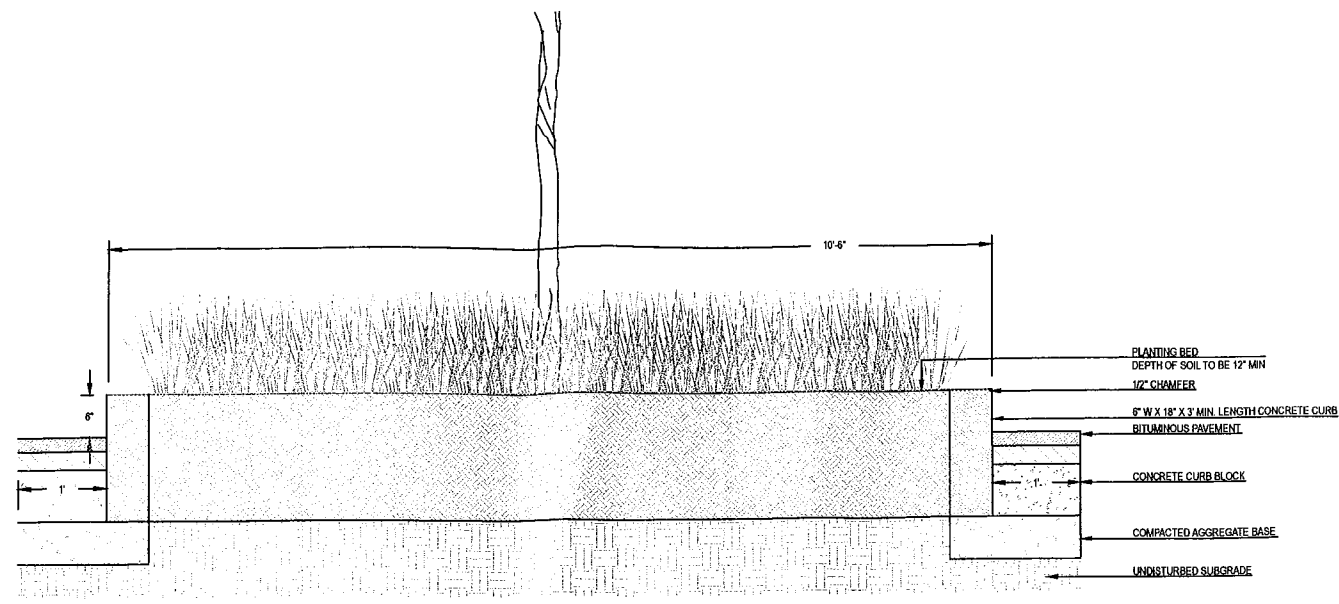

1 PARKING LOT ISLAND CONCRETE CURB AND PLANTING BED
 1" = 1'-0"

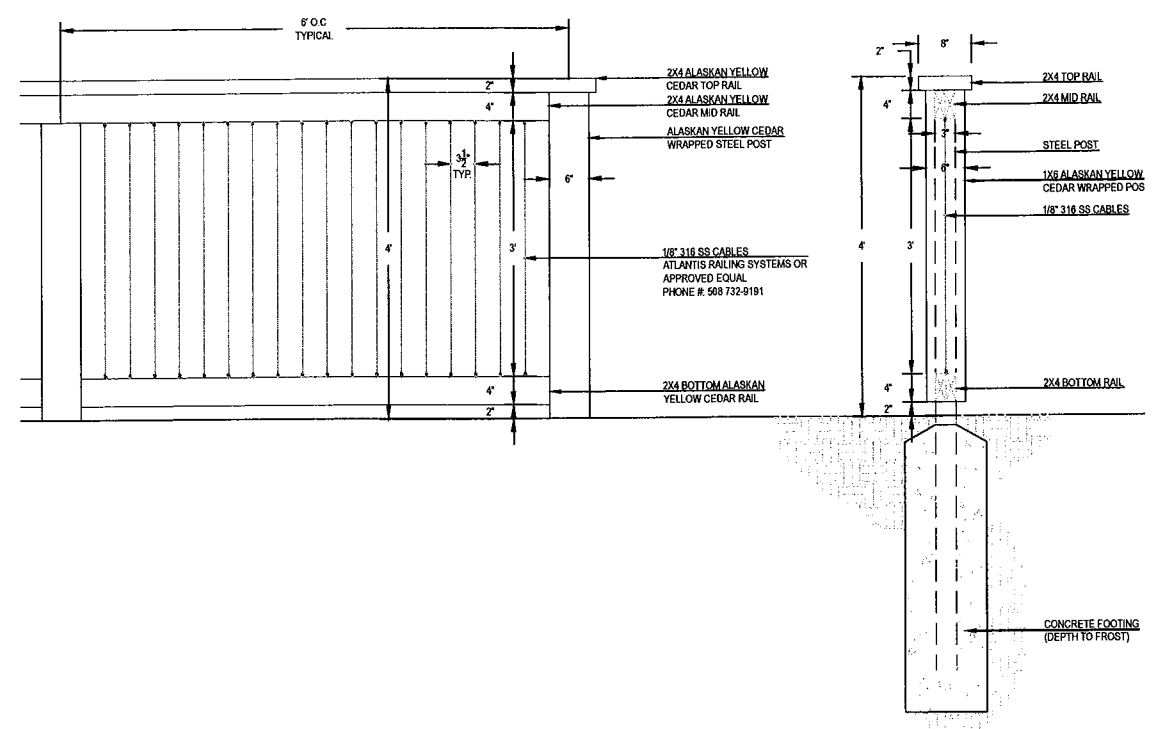

5 4'H VERTICAL CABLE FENCE
 1/2" = 1'-0"

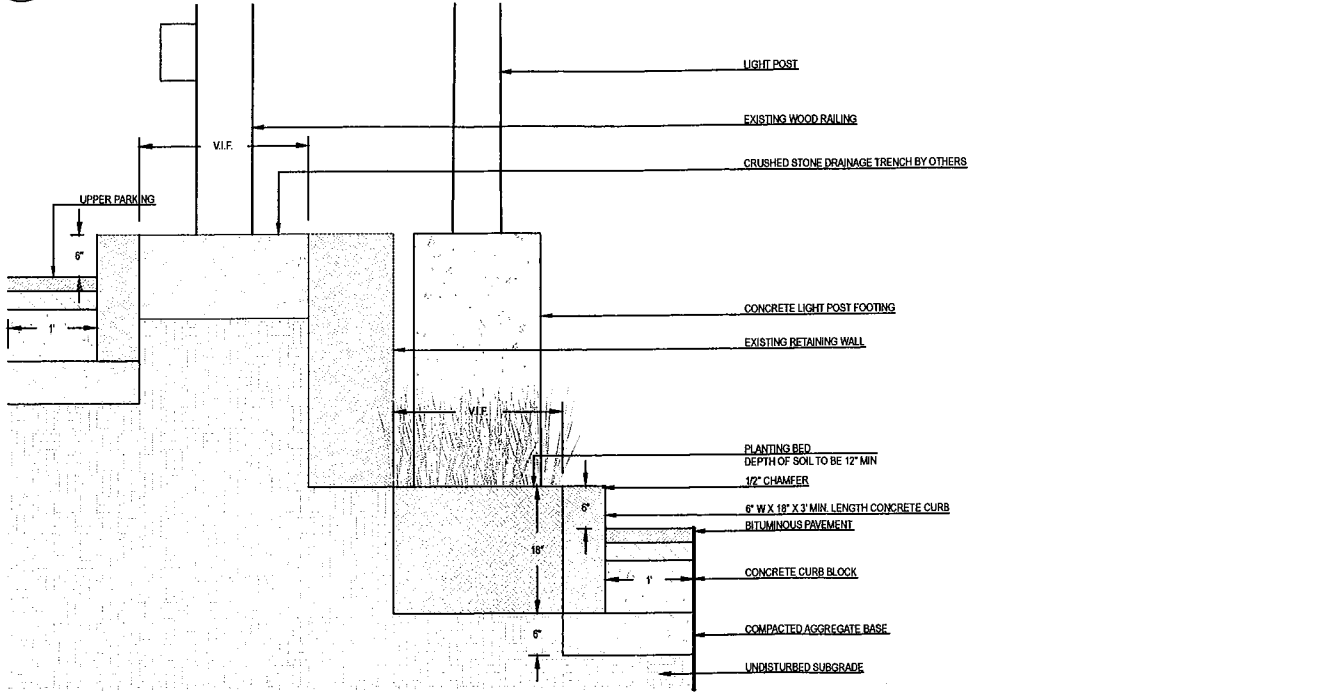

2 PARKING LOT ISLAND SECTION THROUGH LANDSCAPE WALL
 1" = 1'-0"

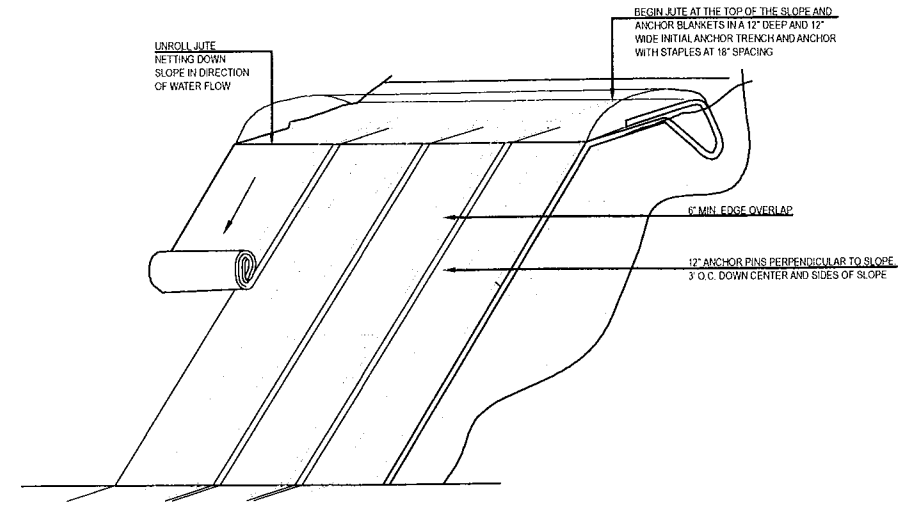

4 JUTE NETTING DOWN SLOPE
 1/4" = 1'-0"

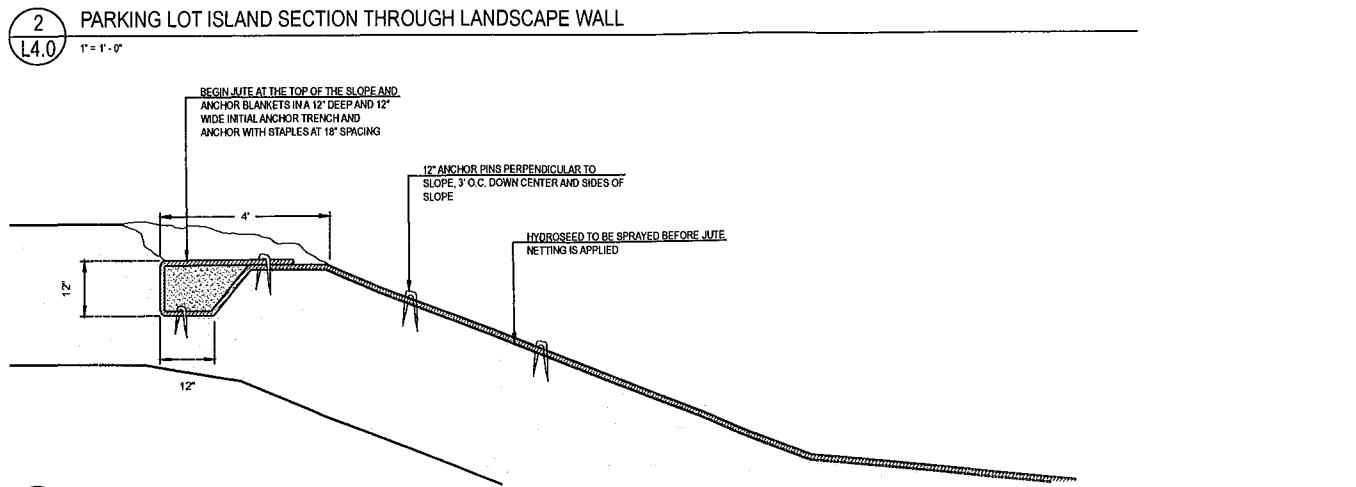

3 JUTE NETTING DOWN SLOPE
 1/2" = 1'-0"

YMCA
 792 VALLEY ROAD
 MIDDLETOWN, RI



PROJECT NUMBER: 19-028
 DRAWN BY: KD
 CHECKED BY: PR
 SCALE: AS NOTED
 DATE: 03.28.2023

REVISIONS:

△	

CONSTRUCTION DETAILS

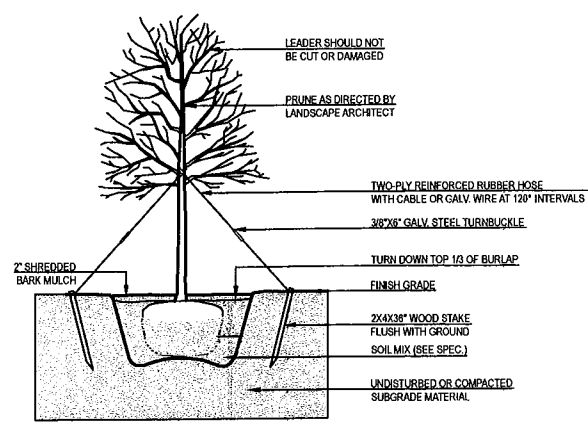

1 DECIDUOUS TREE PLANTING
 L4.2 NTS

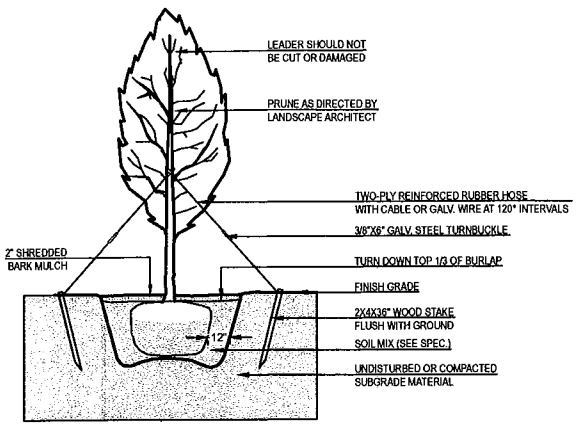

2 EVERGREEN TREE PLANTING
 L4.2 NTS

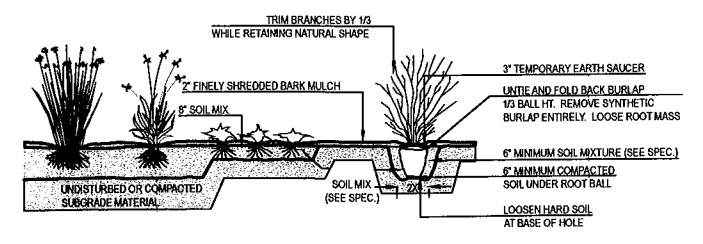

3 PERENNIAL, GROUNDCOVER + SHRUB PLANTING
 L4.2 NTS

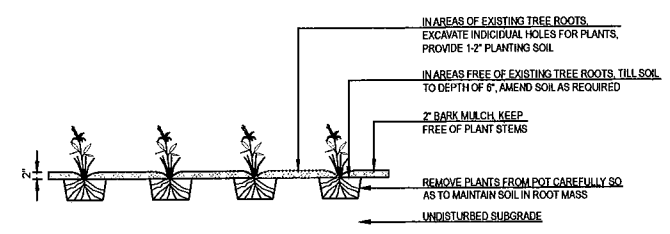
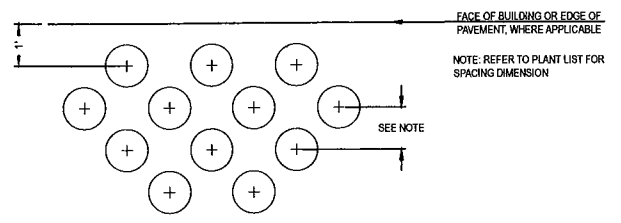

4 GRASS AND PLANT SPACING
 L4.2 NTS

PLANT LIST - SHRUBS | PERENNIALS | GRASSES

SYMBOL	BOTANICAL NAME	COMMON NAME	SPACING
SHRUBS			
ARC LVA	ARCTOSTAPHYLOS LVA-URSI	BEARBERRY	2' O.C.
CLE ALN	CLETHRALNIFOLIA 'HUMMINGBIRD'	HUMMINGBIRD SUMMERSWEET	3-5' O.C.
COR ALB	CORNUS ALBA 'IVORY HALO'	VARIEGATED DOGWOOD	5-6' O.C.
ILE GLA	ILEX GLABRA	INKBERRY	3' O.C.
ILE VER	ILEX VERTICILATA	WINTERBERRY	4' O.C.
MYR PEN	MYRTICA PENNSYLVANICA	WINTERBERRY	4-5' O.C.
VIB DEN	VIBURNUM DENTATUM	ARROWWOOD VIBURNUM	4' O.C.
PERENNIALS			
EUP DUB	EUPATORIUM DUBIUM 'LITTLE JOE'	JOE PYE WEED	2-4' O.C.
HEM VAR	HEMEROCALLIS VAR.	DAYLILY	1-1.5' O.C.
PER ATR	PEROVSKIA ATR 'LITTLE SPIRE'	RUSSIAN SAGE	1.5' O.C.
RUD FUL	RUDEBECKIA FULGIDA V. FULGIDA	CONEFLOWER	1-3' O.C.
SAL CAR	SALVIA CARDONNA	MEADOW SAGE - PURPLE	1.5-2' O.C.
GRASSES			
CAL KAR	CALAMAGROSTIS 'KARL FOERSTER'	FEATHER REED GRASS	2' O.C.
PEN HAM	PENNISETUM A 'HAMELY'	DWARF FOUNTAIN GRASS	2.5' O.C.
PAN VIR	PANICUM VIRGATUM 'SHENANDOAH'	SHENANDOAH SWITCH GRASS	4' O.C.
SCH SCO	SCHIZANCHOYRIUM SCOPARIUM 'CAROUSEL'	CAROUSEL LITTLE BLUESTEM	1.5' O.C.
SES AUT	SESLARIA AUTUMNALIS	AUTUMN MOOR GRASS	18' O.C.
SPO HET	SPOROBOLUS HETEROLEPIS	PRAIRIE DROPSIED	1.5-2' O.C.

5 GRASS AND PLANT SPACING
 L4.2 NTS

YMCA
 792 VALLEY ROAD
 MIDDLETOWN, RI



PROJECT NUMBER: 19.028
 DRAWN BY: KD
 CHECKED BY: PR
 SCALE: AS NOTED
 DATE: 03.28.2023

REVISIONS:

△		

PLANTING DETAILS