

---

PROPOSED  
MINIATURE GOLF  
MIDDLETOWN, RI

---



CONTENTS

---

SHEET #1 - SITE PLAN 1"=20'-0"

SHEET #2 - LAYOUT PLAN 1"=10'-0"

SHEET #3 - GRADING PLAN 1"=10'-0"

SHEET #4 - LAYOUT & GRADING PLAN  
1"=10'-0"

SHEET #5 - LIGHTING PLAN 1"=10'-0"

SHEET #6 - DETAIL SHEET #1

SHEET #7 - DETAIL SHEET #2

SHEET #8 - DETAIL SHEET #3

SHEET #9 - DETAIL SHEET #4

SHEET #10- COLOR RENDERING  
1"=10'-0"

---

PERIMETER  
COURSE FENCE  
(BY OTHERS)

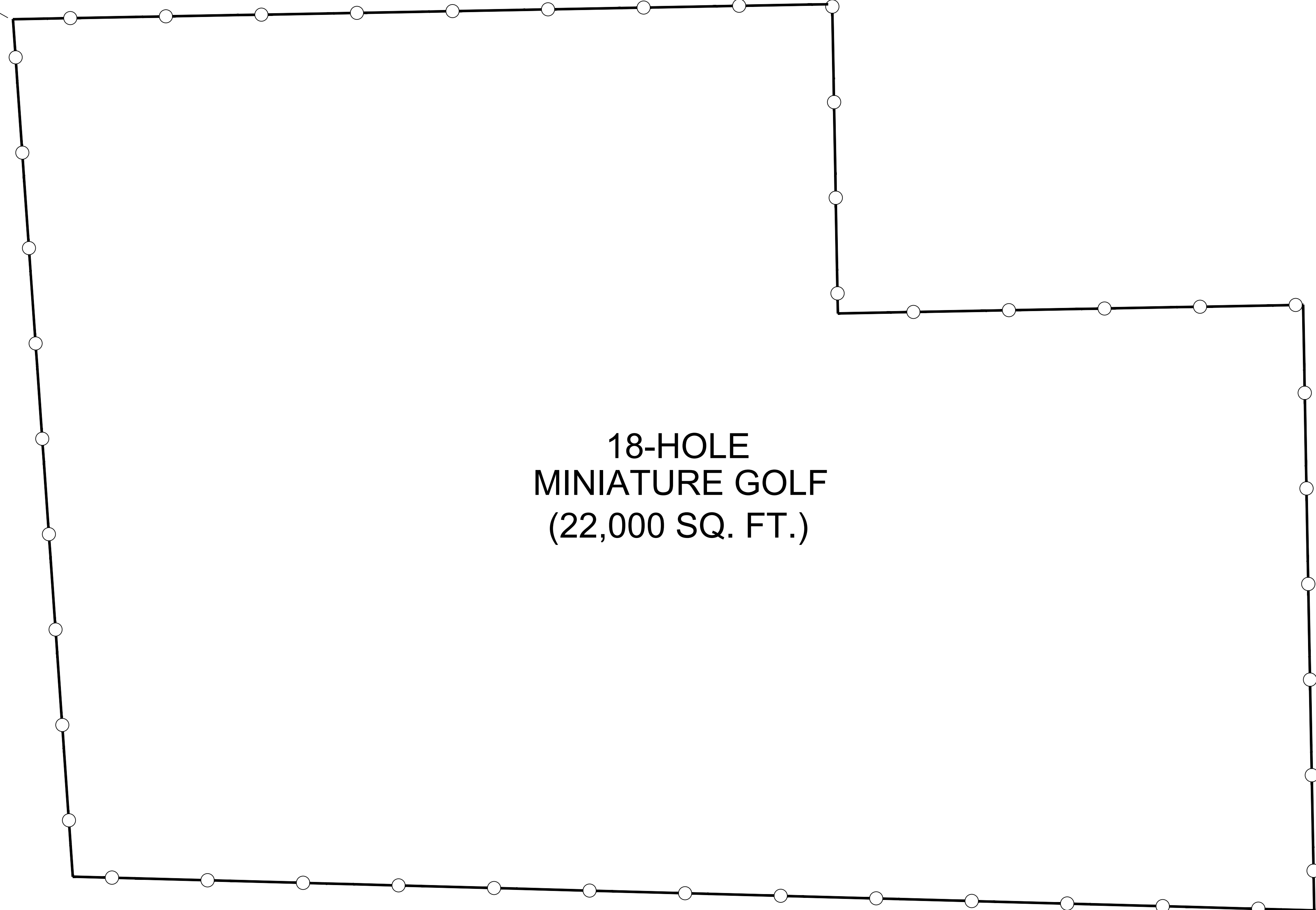

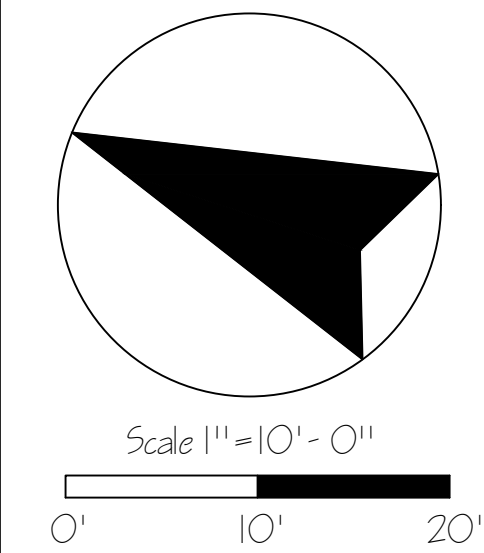

18-HOLE  
MINIATURE GOLF  
(22,000 SQ. FT.)



PROJECT: Proposed Miniature Golf Middletown, RI	
DRAWN BY: J. Onyszczak	DATE: 08/31/21
CHECKED BY: G. Lynn	JOB #: 21-85-2
SITE PLAN	SHEET: 1 OF 10
REVISIONS:	
DATE PRINTED: 09/10/21	

 Handicap accessible portions of the course(s) are designed in accordance with ADAAG (Americans with Disabilities Act Accessibility Guidelines) Chapter 10 Section 1007.

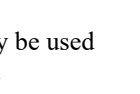
REUSE OF DOCUMENTS:  
This document, and the designs incorporated herein, are the property of Harris Miniature Golf Courses, Inc. and are not to be used in whole or in part for construction of this, or any other project without written authorization of Harris Miniature Golf Courses, Inc.

- GRAPHICS LEGEND:
- R- Rough 
  - ST- Sand Trap 
  - \*Note: color carpet may be used in place of natural sand
  - Elevation Change 
  - Embankment 

PERIMETER COURSE FENCE (BY OTHERS)

COIN DROP PIPE SHOT

BALL-IN-WATER SHOT

PILING BRIDGE (TYP.)

PIPE SHOT

POST W/ ADA SIGN

ADA LOOP

BOULDER WATERFALL

BOULDER (TYP.)

PRACTICE GREEN

SPRAY FOUNTAIN (TYP.)

PROPOSED LIGHT POLE & FIXTURE BY OTHERS (TYP.)

RETAINING WALL (TYP.)

BOULDER ARCH

JUMP SHOT

PUMP #2: SPRAY FOUNTAIN SYSTEM (1.5hp)

POST & ROPE (TYP.)

APPROXIMATE LOCATION OF PUMP HOUSING (TYP.)

PUMP #1: NATURAL ROCK WATERFALL SYSTEM (5hp)

BRICK PAVER EDGING (TYP.)

TEXTURED STREAMS & PONDS (TYP.)

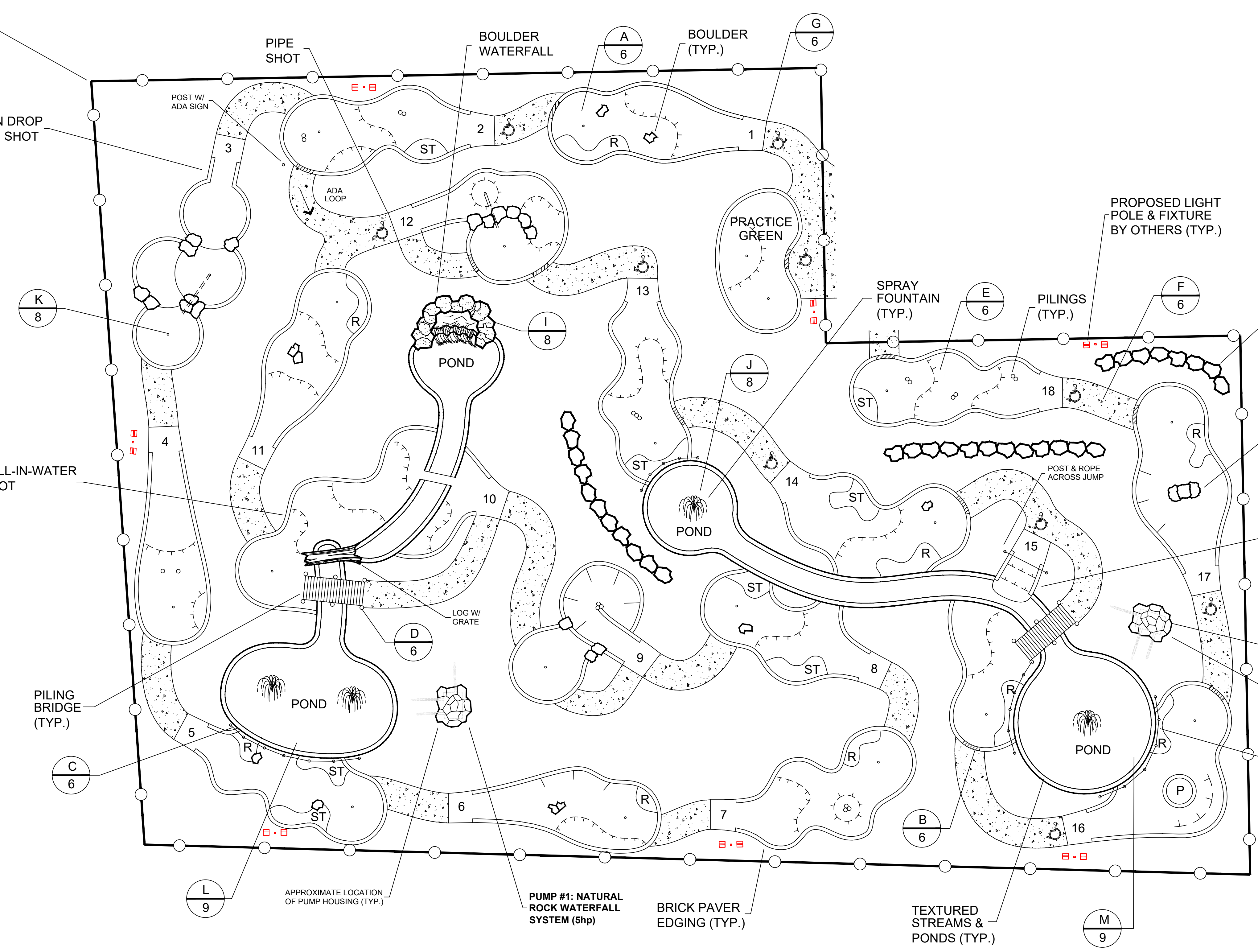

**NOTES:**

- All concrete on site shall be a fiber mesh based concrete with a 3500 P.S.I. rating.
- Motor starters or timers should be used to turn pumps on/off. Harris cannot warrant pumps that are controlled by breakers alone.
- Three Phase available but motor starter is required. Please consult your electrician in choosing appropriate pump assembly.
- Owner MUST request Three Phase pumps IN WRITING.
- It is strongly recommended that a buck & boost transformer be installed if a single phase leg is taken from 3-phase service to power the pumps, due to the unstable voltage of this arrangement.
- Spray fountain heads in lower ponds MUST be HIGHER than pump.



Handicap accessible portions of the course(s) are designed in accordance with ADAAG (Americans with Disabilities Act Accessibility Guidelines) Chapter 10 Section 1007.

**REUSE OF DOCUMENTS:**

This document, and the designs incorporated herein, are the property of Harris Miniature Golf Courses, Inc. and are not to be used in whole or in part for construction of this, or any other project without written authorization of Harris Miniature Golf Courses, Inc.

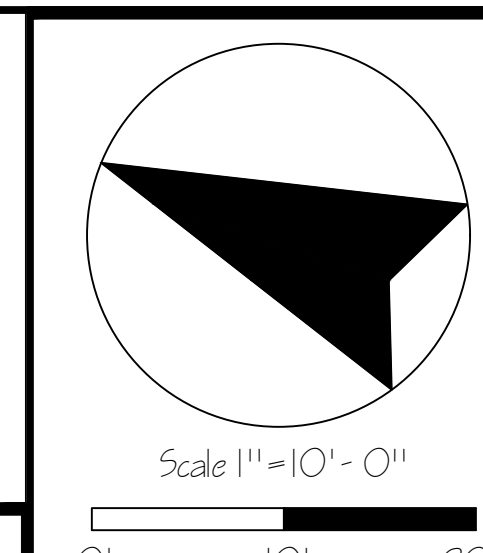

**GRAPHICS LEGEND:**

- R- Rough
- ST- Sand Trap
- \*Note: color carpet may be used in place of natural sand
- Elevation Change
- Embankment
- P- Planter

PROJECT: Proposed Miniature Golf Middletown, RI	
DRAWN BY: J. Onyschczak	DATE: 08/31/21
CHECKED BY: G. Lynn	JOB #: 21-85-2
LAYOUT PLAN	SHEET: 2 OF 10
REVISIONS:	
DATE PRINTED: 09/10/21	

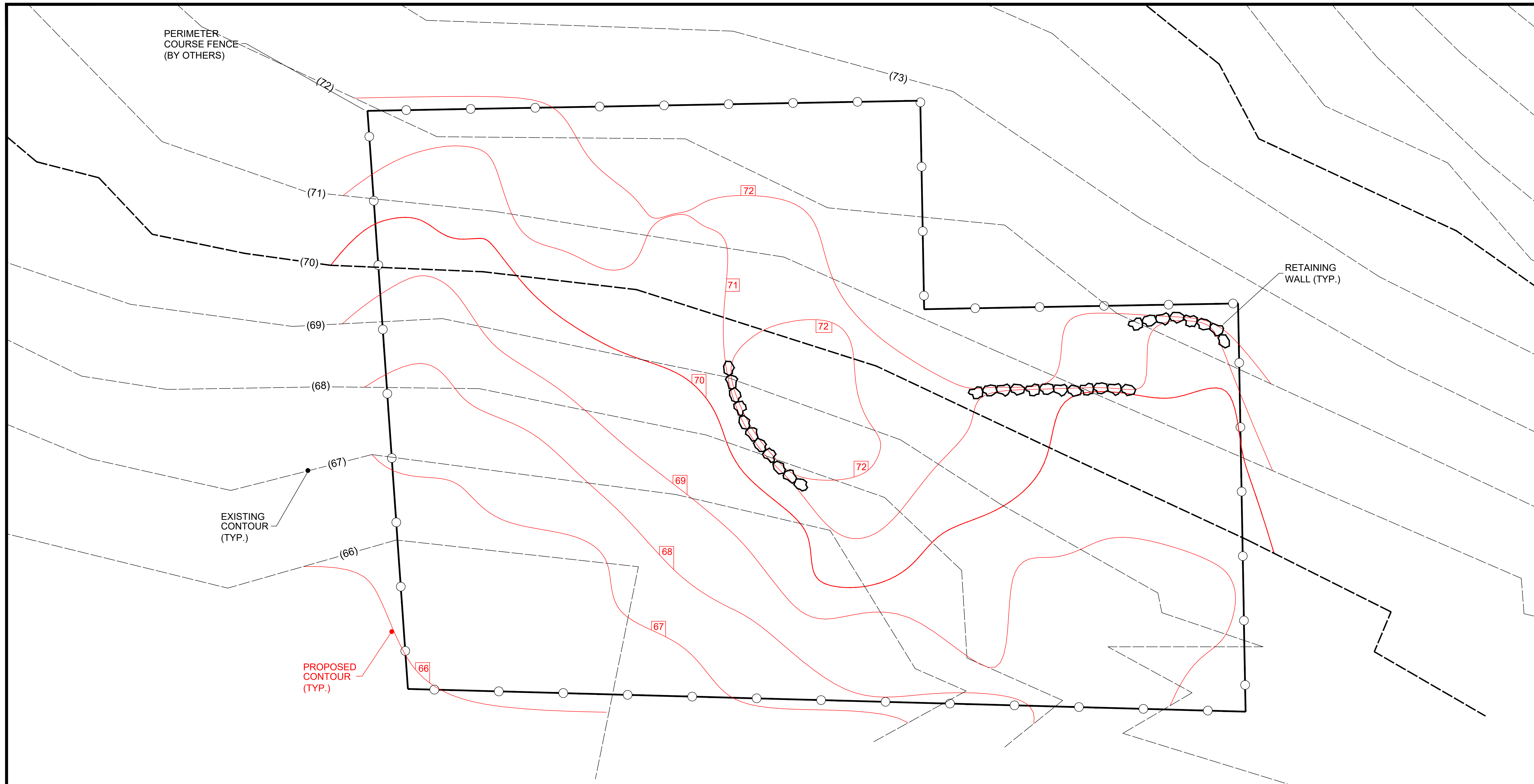

PERIMETER COURSE FENCE (BY OTHERS)

RETAINING WALL (TYP.)

EXISTING CONTOUR (TYP.)

PROPOSED CONTOUR (TYP.)

**NOTES:**

-Elevations shown on this grading plan represent proposed rough grades. Fine grading for holes, walkways, and water systems will be done in the field.

-When bringing in fill, Harris recommends using a granular, self-draining, compactable fill. Fill should be ROLLED and COMPACTED in 6" - 12" lifts to reduce SETTLING. Harris also recommends having additional fill available for the shaping and contouring of the golf holes, walks, and water systems.

-Elevations must be CLEARLY MARKED with GRADE STAKES to ENSURE and VERIFY that the grading plan has been done properly and to the specifications of this plan provided by Harris Miniature Golf Courses, Inc.

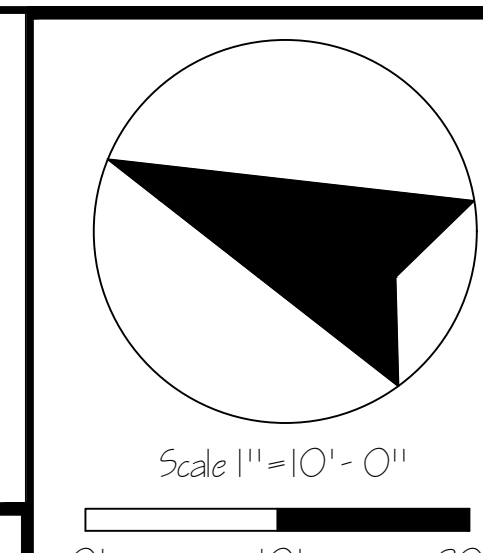

Handicap accessible portions of the course(s) are designed in accordance with ADAAG (Americans with Disabilities Act Accessibility Guidelines) Chapter 10 Section 1007.

**REUSE OF DOCUMENTS:**  
This document, and the designs incorporated herein, are the property of Harris Miniature Golf Courses, Inc. and are not to be used in whole or in part for construction of this, or any other project without written authorization of Harris Miniature Golf Courses, Inc.

**GRAPHICS LEGEND:**

- R- Rough
- ST- Sand Trap
- \*Note: color carpet may be used in place of natural sand
- Elevation Change
- Embankment

PROJECT: Proposed Miniature Golf Middletown, RI

DRAWN BY: J. Onyszczak DATE: 08/31/21

CHECKED BY: G. Lynn JOB #: 21-85-2

GRADING PLAN SHEET: 3 OF 10

REVISIONS:

DATE PRINTED: 09/01/22

PERIMETER COURSE FENCE (BY OTHERS)

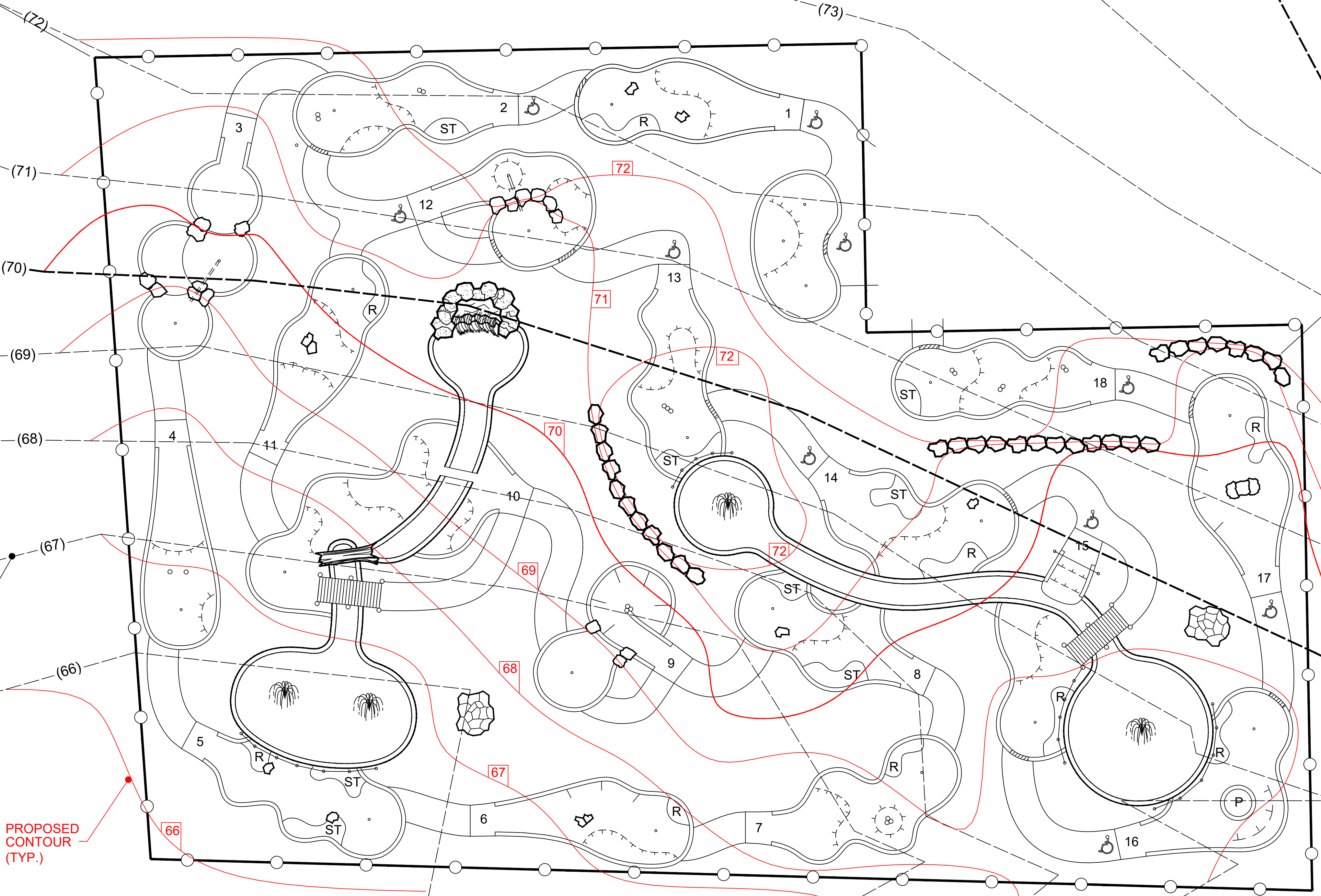

RETAINING WALL (TYP.)

EXISTING CONTOUR (TYP.)

PROPOSED CONTOUR (TYP.)

**NOTES:**

- Elevations shown on this grading plan represent proposed rough grades. Fine grading for holes, walkways, and water systems will be done in the field.
- When bringing in fill, Harris recommends using a granular, self-draining, compactable fill. Fill should be ROLLED and COMPACTED in 6" - 12" lifts to reduce SETTLING. Harris also recommends having additional fill available for the shaping and contouring of the golf holes, walks, and water systems.
- Elevations must be CLEARLY MARKED with GRADE STAKES to ENSURE and VERIFY that the grading plan has been done properly and to the specifications of this plan provided by Harris Miniature Golf Courses, Inc.

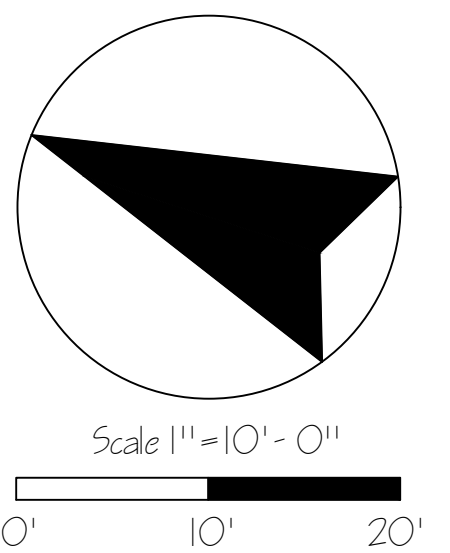

Handicap accessible portions of the course(s) are designed in accordance with ADAAG (Americans with Disabilities Act Accessibility Guidelines) Chapter 10 Section 1007.

**REUSE OF DOCUMENTS:**  
This document, and the designs incorporated herein, are the property of Harris Miniature Golf Courses, Inc. and are not to be used in whole or in part for construction of this, or any other project without written authorization of Harris Miniature Golf Courses, Inc.

**GRAPHICS LEGEND:**  
 R- Rough  
 ST- Sand Trap  
 \*Note: color carpet may be used in place of natural sand  
 Elevation Change  
 Embankment

PROJECT: Proposed Miniature Golf Middletown, RI	
DRAWN BY: J. Onyszczak	DATE: 08/31/21
CHECKED BY: G. Lynn	JOB #: 21-85-2
LAYOUT & GRADING PLAN	SHEET: 4 OF 10
REVISIONS:	
DATE PRINTED: 09/01/22	

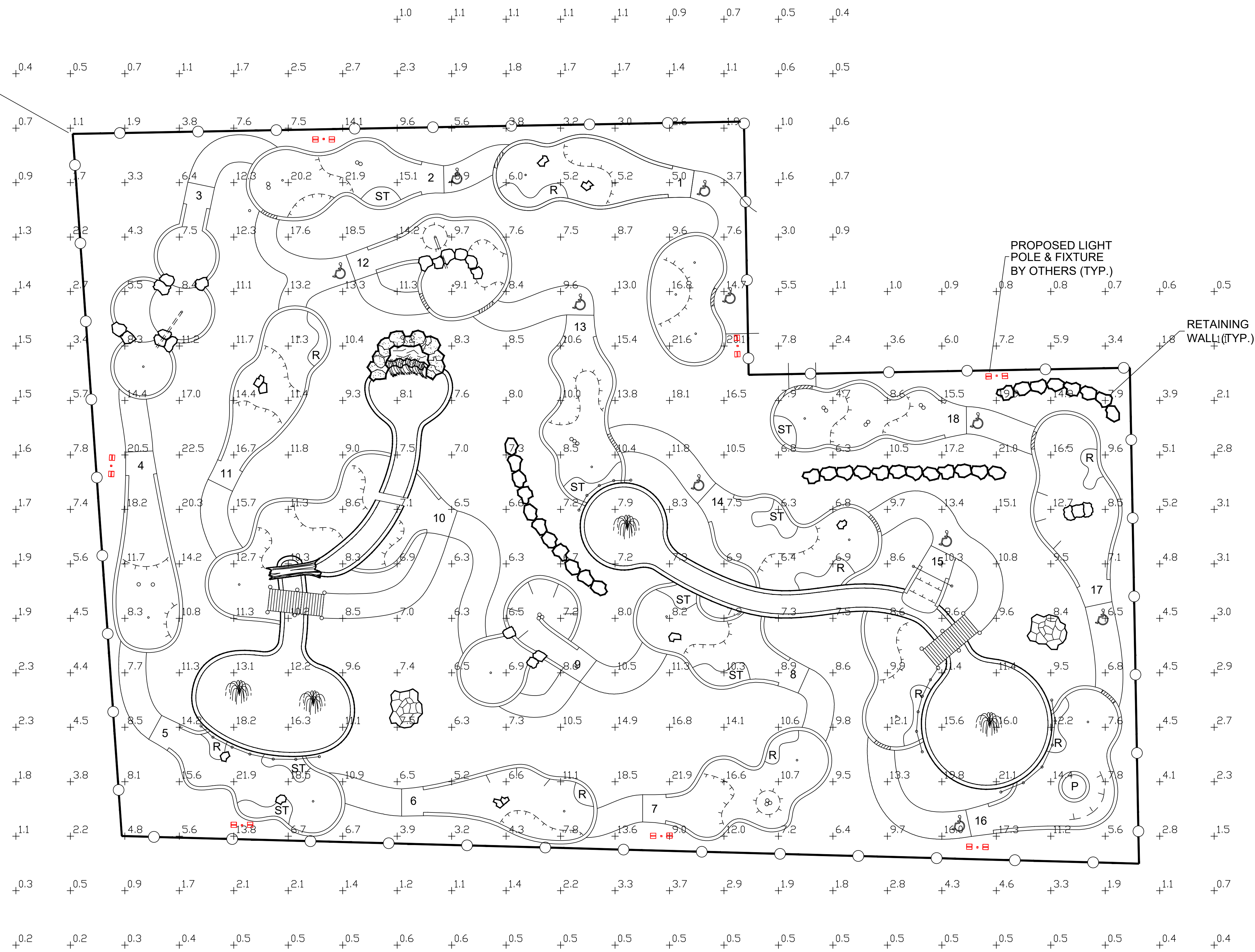
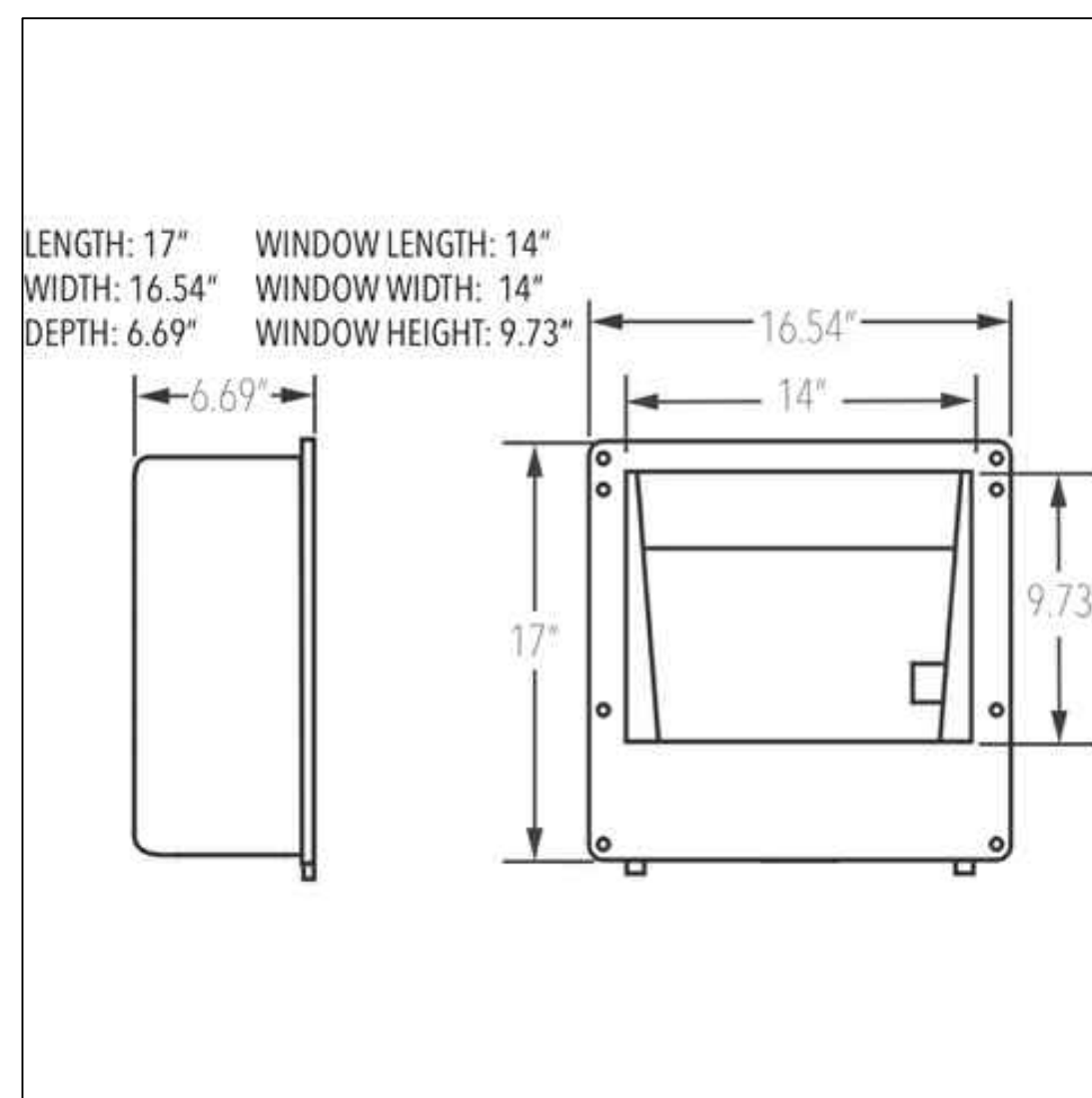
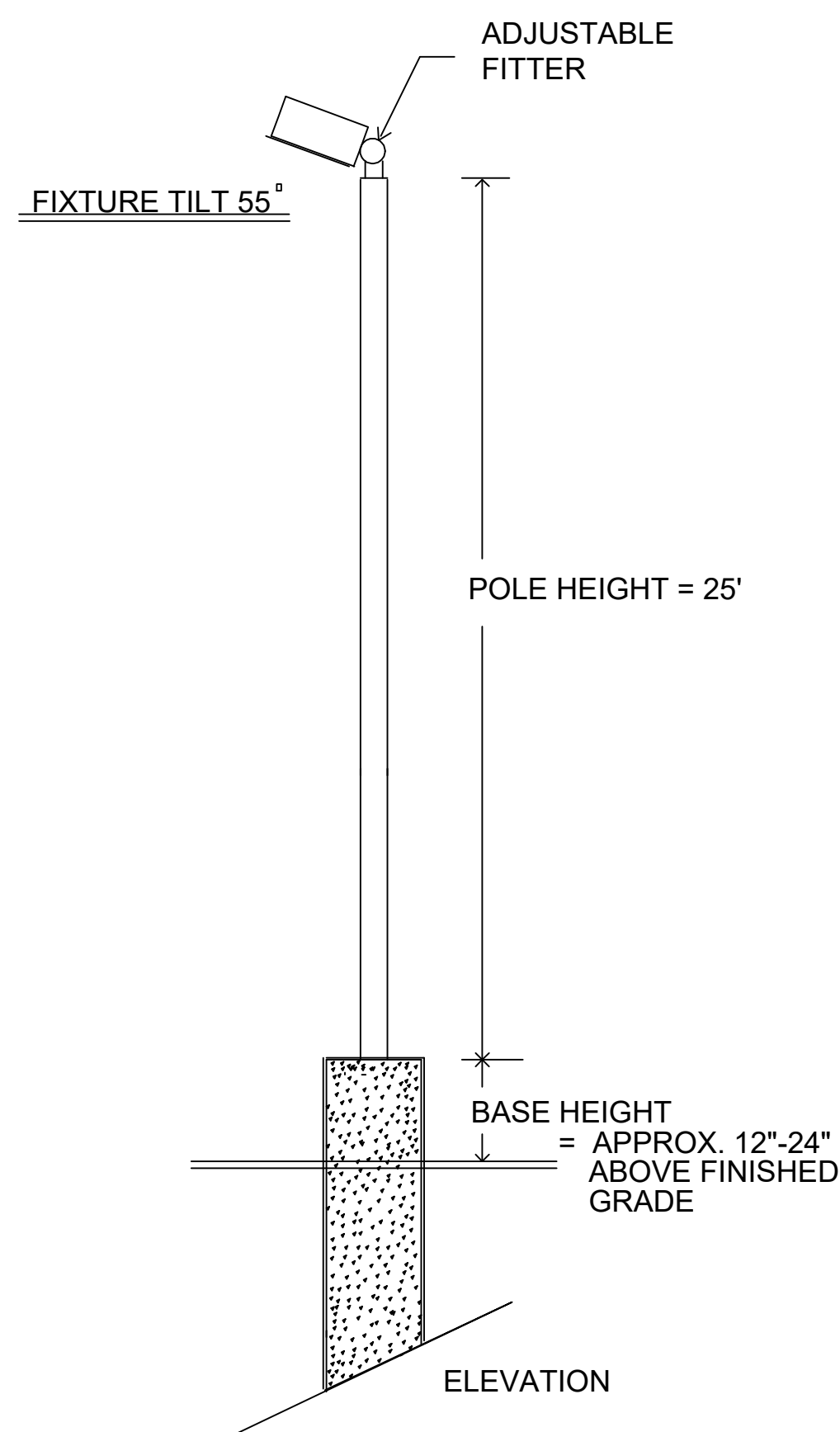

Luminaire Schedule					
Symbol	Qty	Description	Part Number	Nominal Lumens	Wattage
■ • ■	7	16" Shoebox Hercules Area & Flood Lights, Olympia Series	16-SBHC-240-50-MV-5	31,849	211w LED 235w System

Numeric Summary					
Label	Symbol	Units	Avg	Max	Min
Calc Zone #1	+0.0	Fc	9.6	26.0	0.7

**NOTES:**

-Illumination results shown on this lighting design are based on project parameters provided to Harris Miniature Golf Courses, Inc. used in conjunction with luminaire test procedure conducted under laboratory conditions. Actual project conditions differing from these design parameters may affect field results. The customer is responsible for verifying compliance with any applicable electrical, lighting, and/or energy codes.



Handicap accessible portions of the course(s) are designed in accordance with ADAAG (Americans with Disabilities Act Accessibility Guidelines) Chapter 10 Section 1007.

**REUSE OF DOCUMENTS:**

This document, and the designs incorporated herein, are the property of Harris Miniature Golf Courses, Inc. and are not to be used in whole or in part for construction of this, or any other project without written authorization of Harris Miniature Golf Courses, Inc.

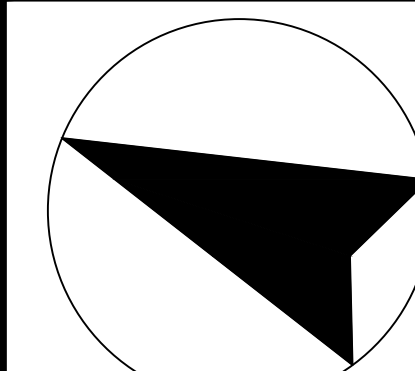

Scale 1" = 10' - 0"

**GRAPHICS LEGEND:**

- R- Rough
- ST- Sand Trap
- \*Note: color carpet may be used in place of natural sand
- Elevation Change
- Embankment

PROJECT: Proposed Miniature Golf Middletown, RI

DRAWN BY: J. Onyszczak DATE: 08/31/21

CHECKED BY: G. Lynn JOB #: 21-85-2

LIGHTING PLAN SHEET: 5 OF 10

REVISIONS:	

DATE PRINTED: 09/01/22

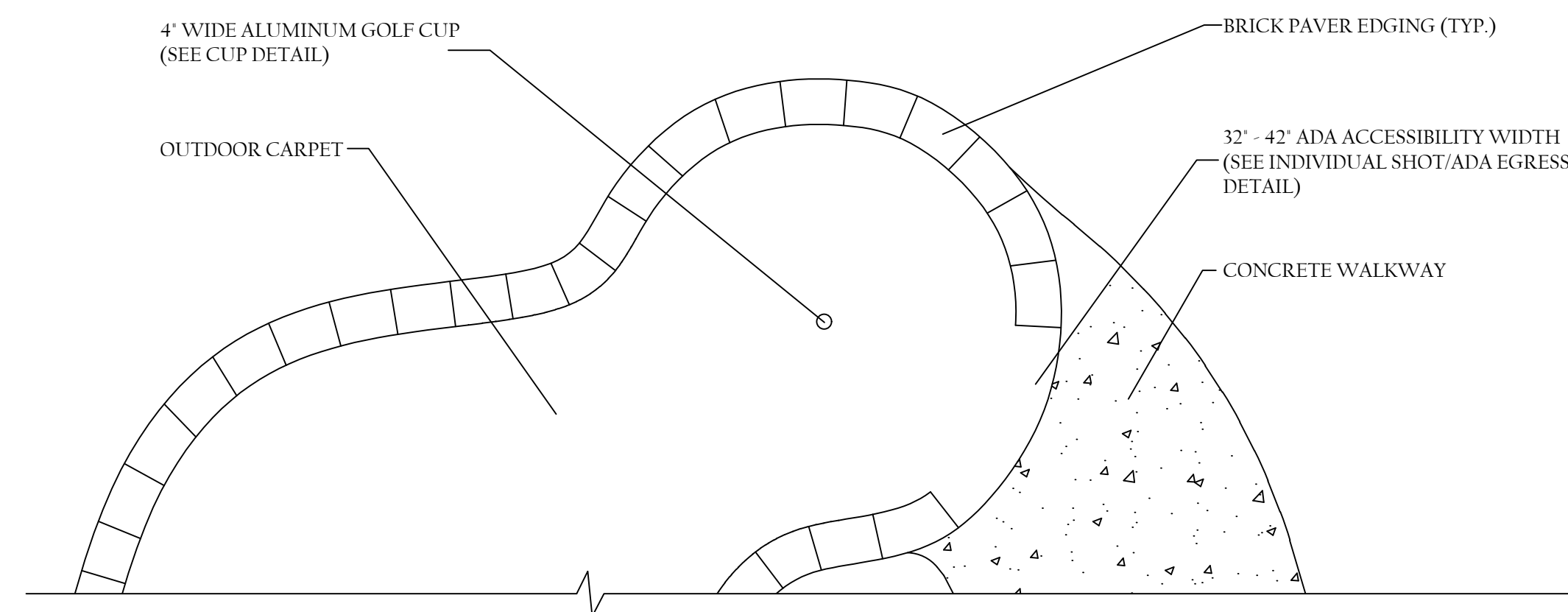

**A**  
**6** PLAN VIEW OF GREEN DETAIL  
NOT TO SCALE

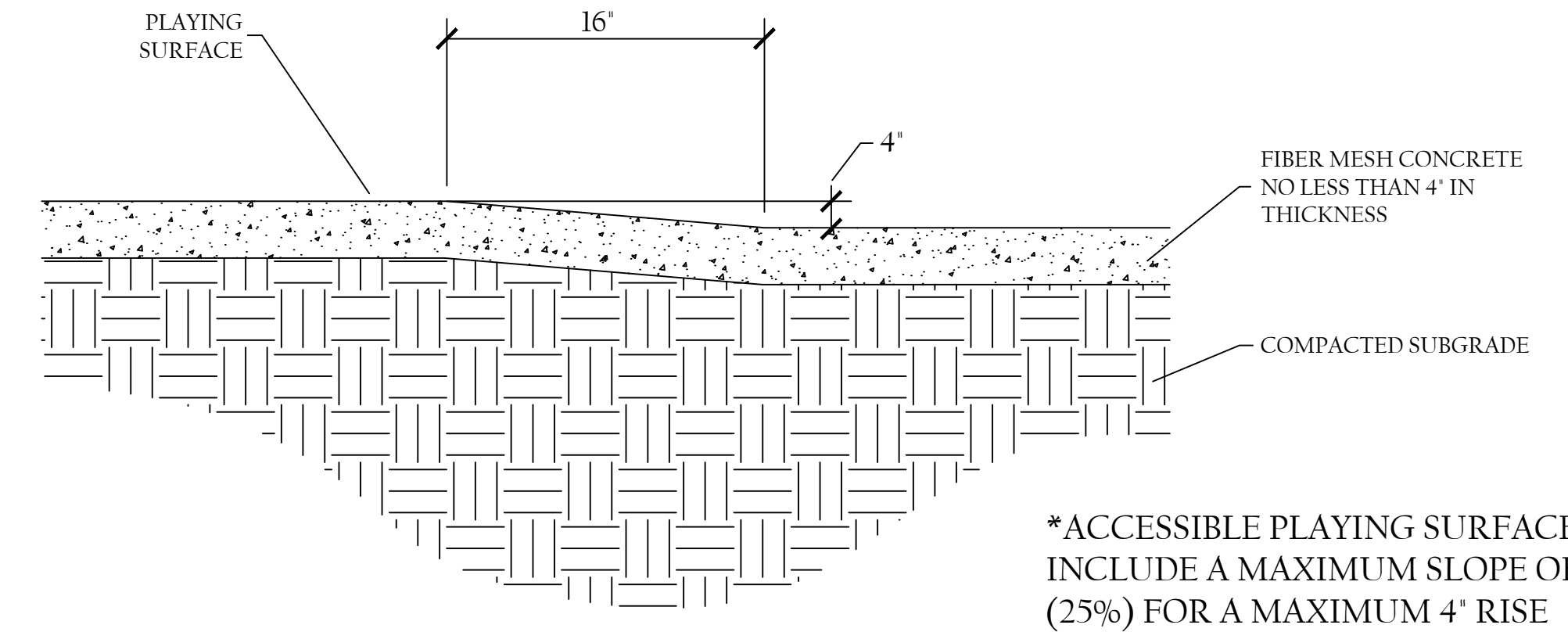
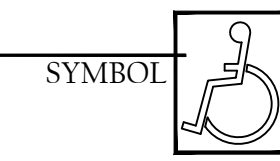

**E**  
**6** ELEVATION CHANGE- ADA PLAYING SURFACE (TYP.)  
NOT TO SCALE

\*ACCESSIBLE PLAYING SURFACES MAY INCLUDE A MAXIMUM SLOPE OF 1:4 (25%) FOR A MAXIMUM 4' RISE

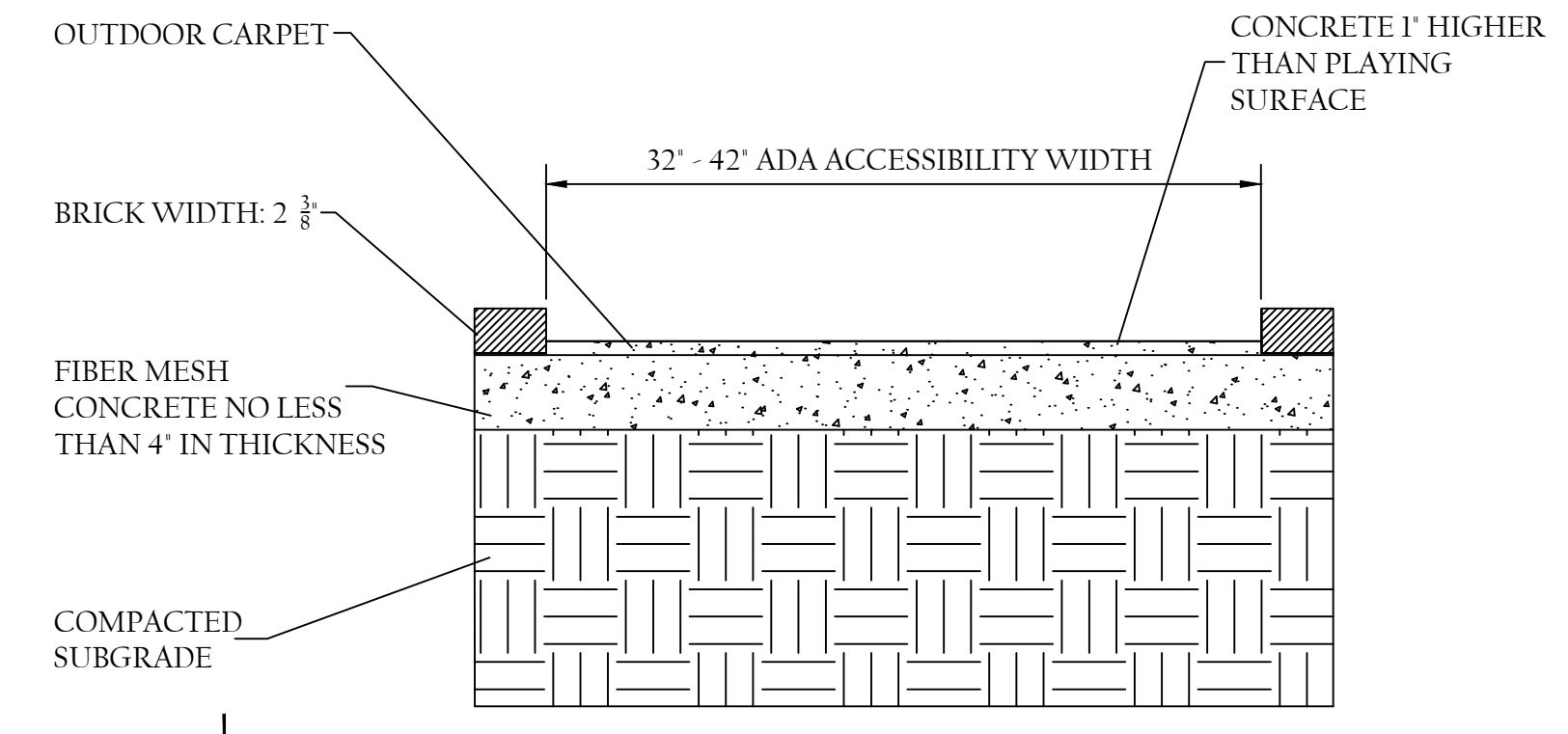
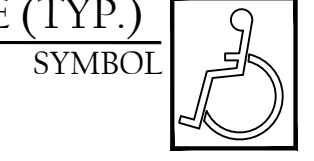

**B**  
**6** INDIVIDUAL SHOT / ADA EGRESS DETAIL  
NOT TO SCALE

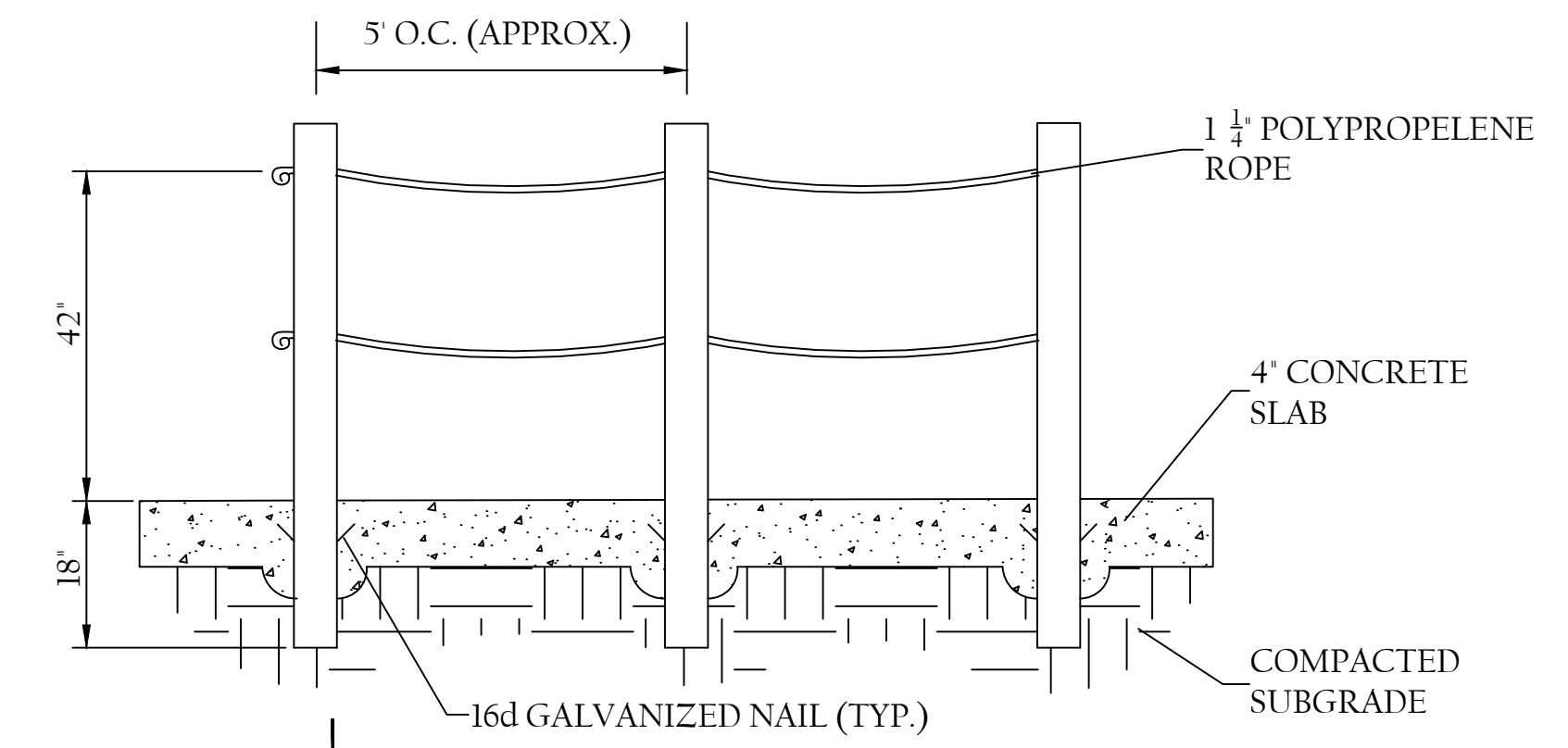
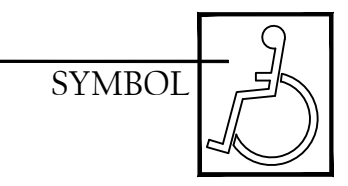

**C**  
**6** POST & ROPE SECTION DETAIL  
NOT TO SCALE

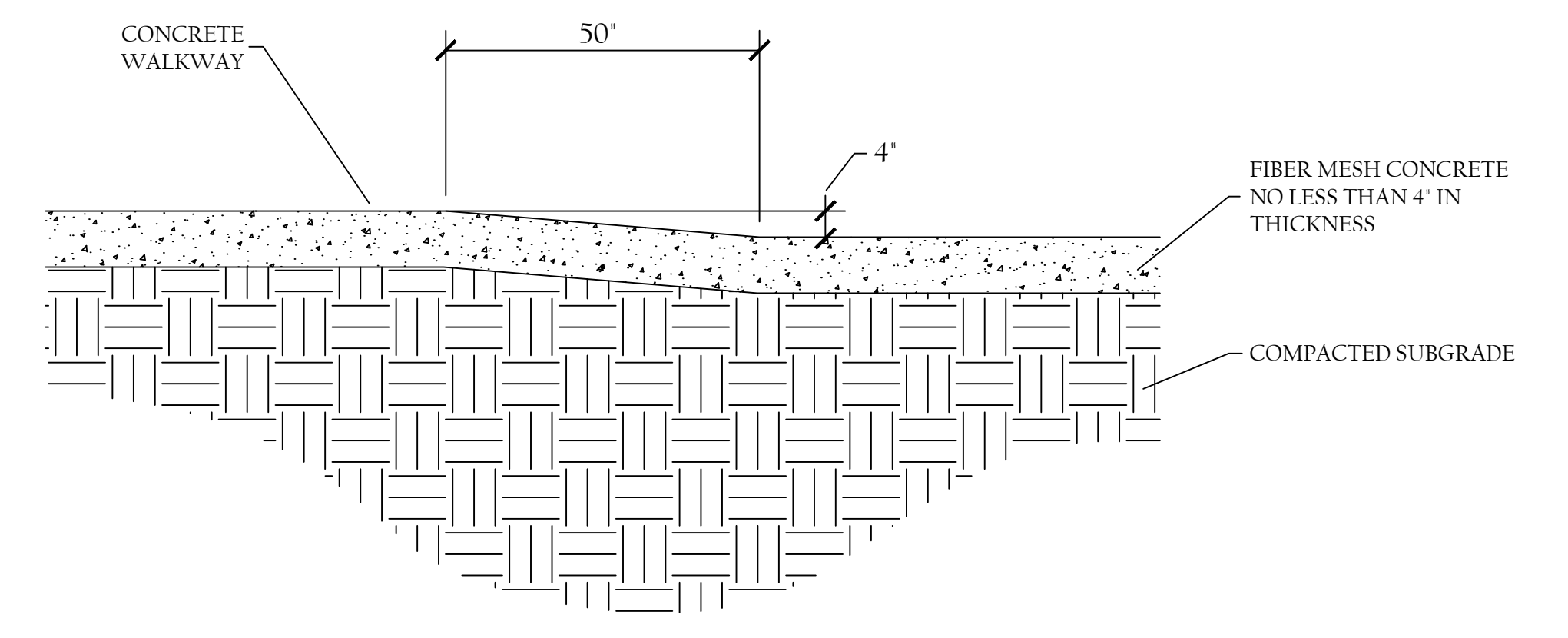

**F**  
**6** ELEVATION CHANGE- ADA WALKWAY (TYP.)  
NOT TO SCALE

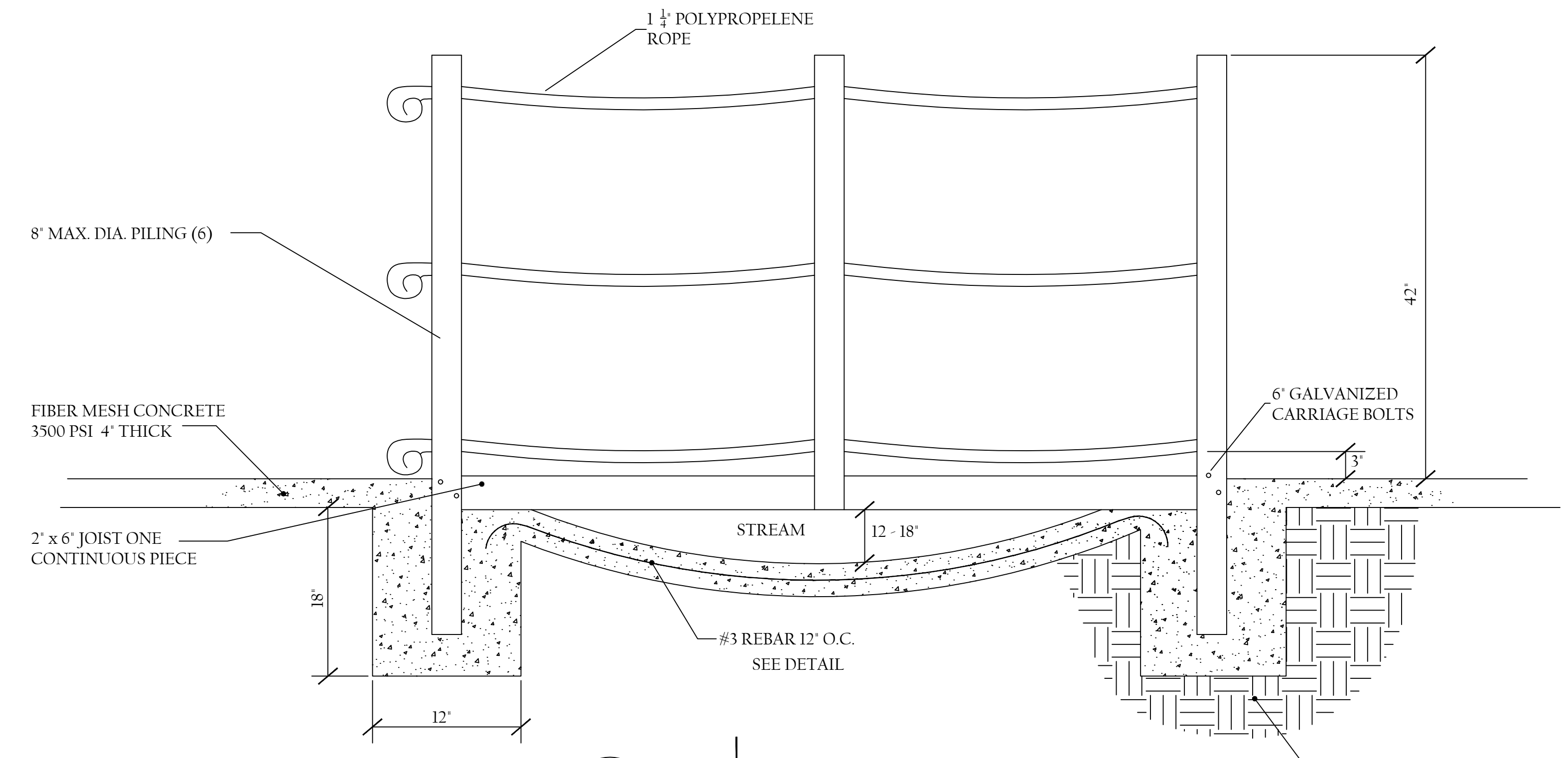
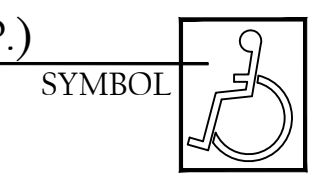

**D**  
**6** PILING BRIDGE DETAIL  
NOT TO SCALE

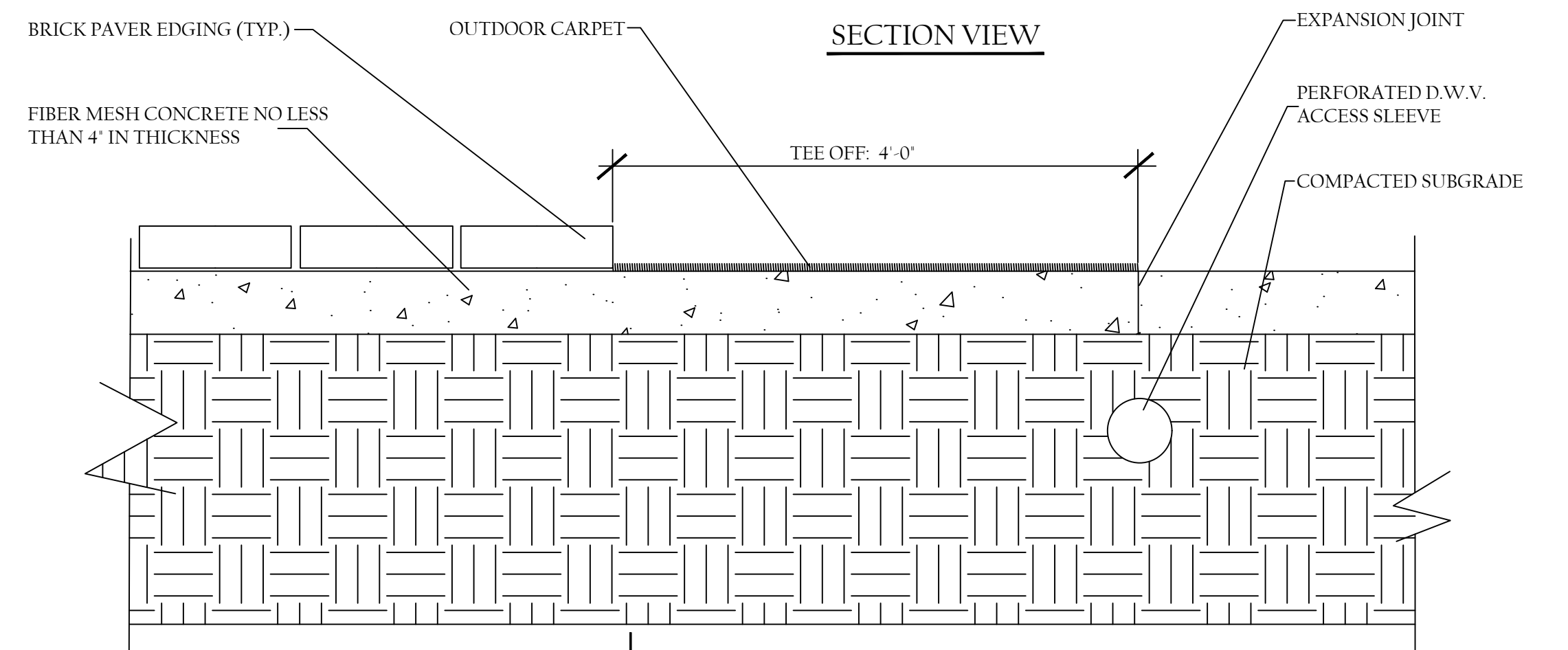

**G**  
**6** INDIVIDUAL SHOT SLEEVE DETAIL  
NOT TO SCALE



NOTES:  
- ALL CONCRETE ON SITE SHALL BE A FIBER MESH BASED CONCRETE WITH A 3500 P.S.I. RATING

Handicap accessible portions of the course(s) are designed in accordance with ADAAG (Americans with Disabilities Act Accessibility Guidelines) Chapter 10 Section 1007.

REUSE OF DOCUMENTS:  
This document, and the designs incorporated herein, are the property of Harris Miniature Golf Courses, Inc. and are not to be used in whole or in part for construction of this, or any other project without written authorization of Harris Miniature Golf Courses, Inc.

PROJECT: Proposed Miniature Golf Middletown, RI

DRAWN BY: J. Onyszczak DATE: 08/31/21

CHECKED BY: G. Lynn JOB #: 21-85-2

DETAIL SHEET #1 SHEET: 6 OF 10

REVISIONS:

DATE PRINTED: 09/01/22

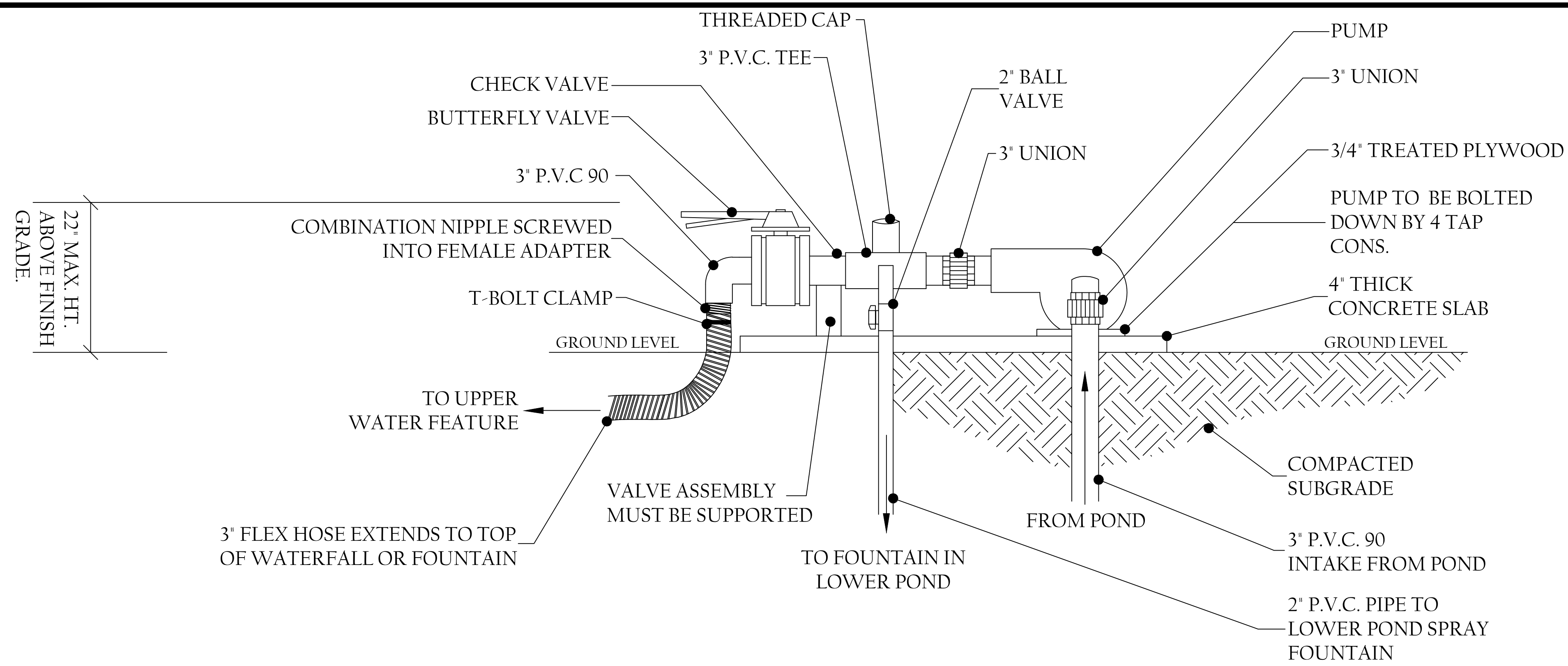

**H**  
**7** PUMP DETAIL - SIDE VIEW  
NOT TO SCALE

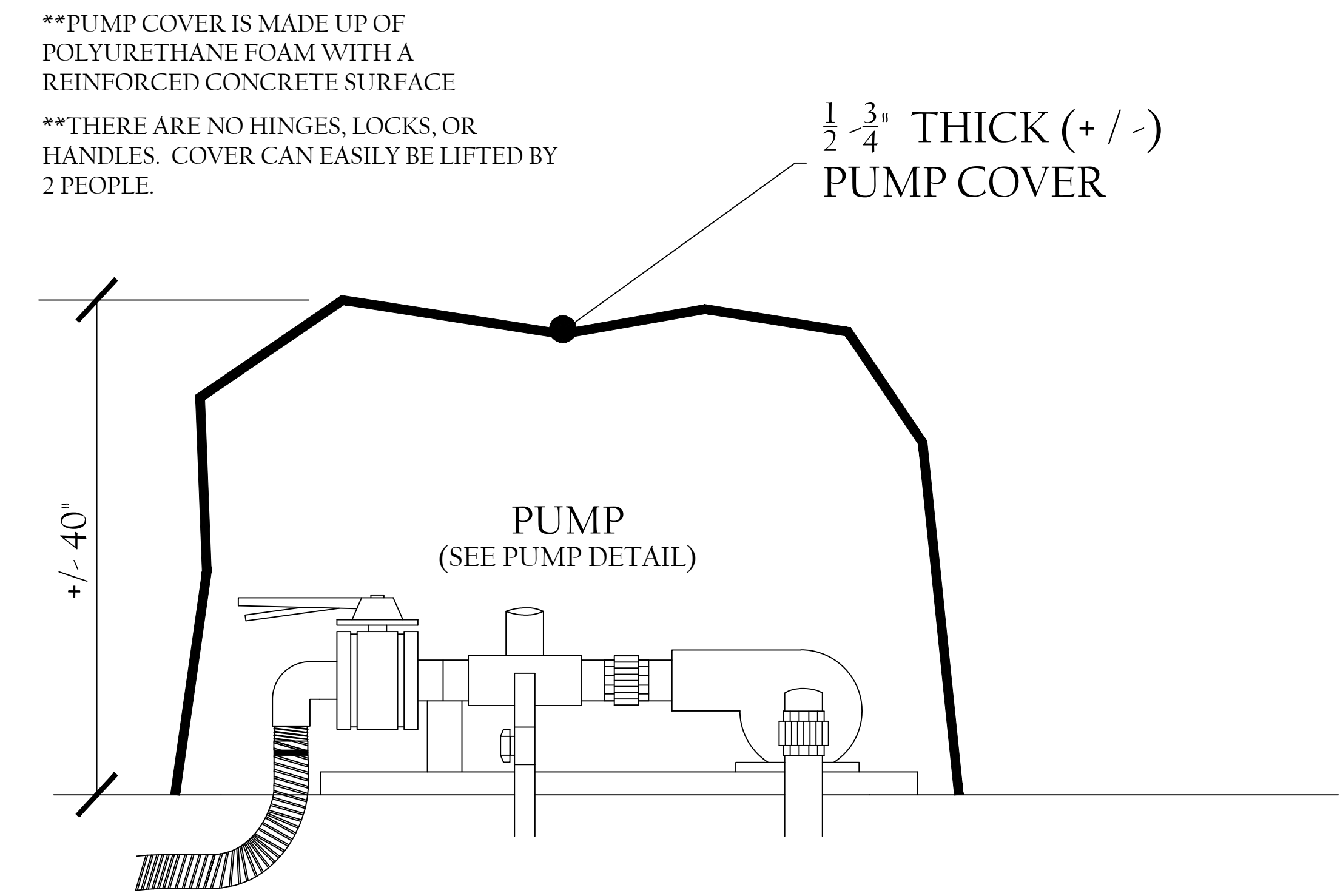

PUMP COVER - SIDE VIEW  
NOT TO SCALE

\*\*PUMP COVER IS MADE UP OF POLYURETHANE FOAM WITH A REINFORCED CONCRETE SURFACE  
\*\*THERE ARE NO HINGES, LOCKS, OR HANDLES. COVER CAN EASILY BE LIFTED BY 2 PEOPLE.

$\frac{1}{2}$  -  $\frac{3}{4}$ " THICK (+/-)  
PUMP COVER

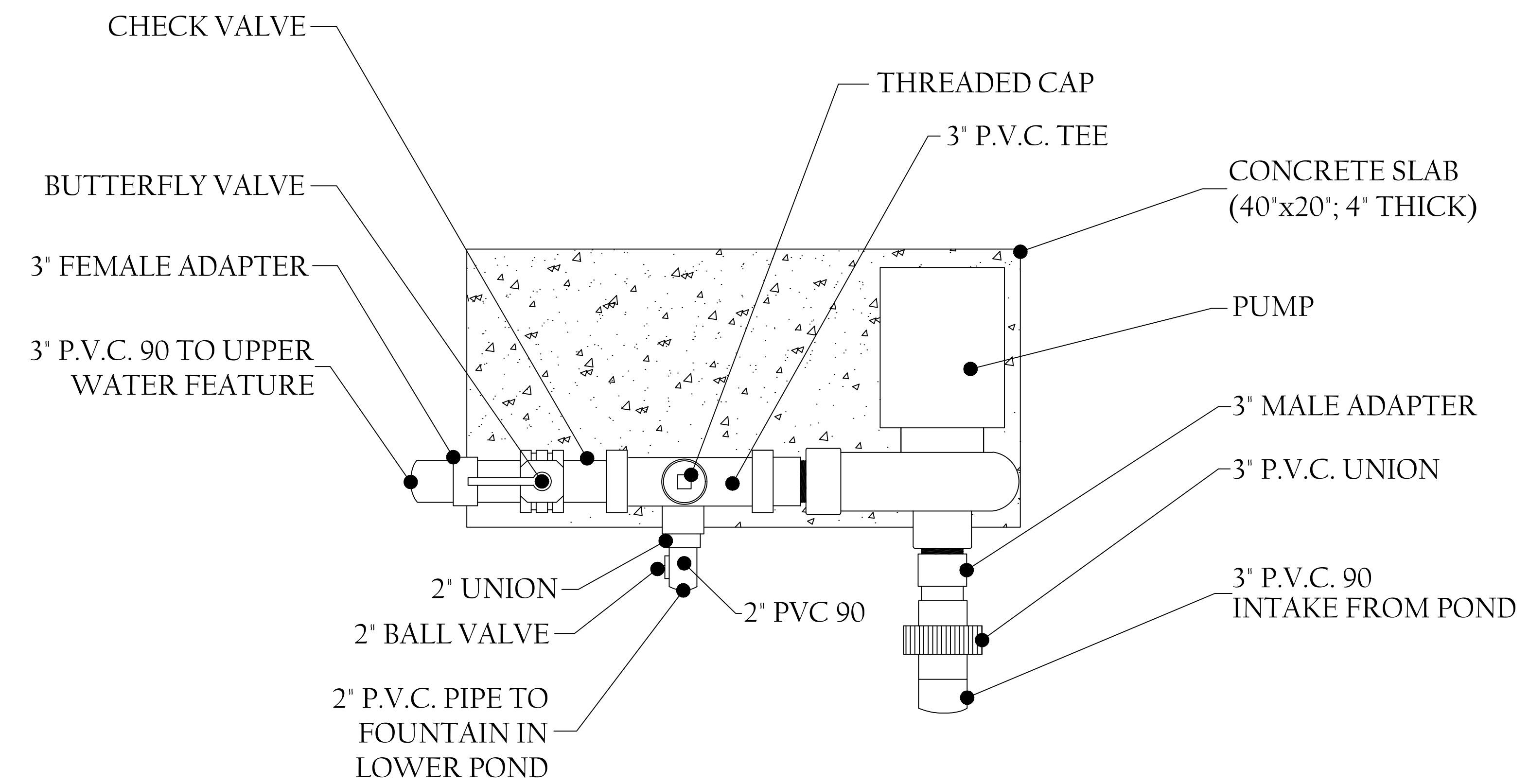

PUMP DETAIL - TOP VIEW  
NOT TO SCALE

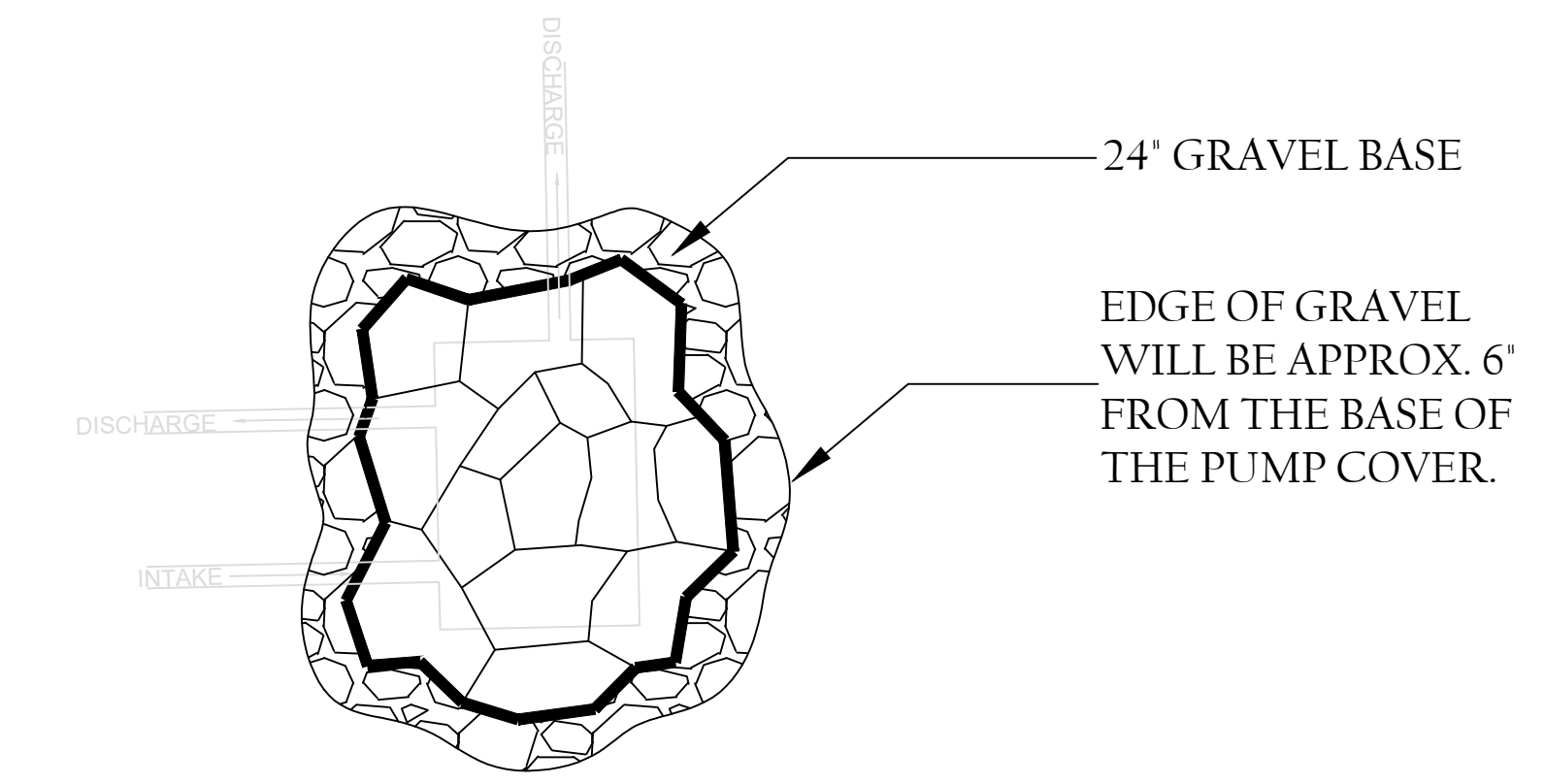

PUMP COVER - TOP VIEW  
NOT TO SCALE



NOTES:  
- ALL CONCRETE ON SITE SHALL BE A FIBER MESH BASED CONCRETE WITH A 3500 P.S.I. RATING

Handicap accessible portions of the course(s) are designed in accordance with ADAAG (Americans with Disabilities Act Accessibility Guidelines) Chapter 10 Section 1007.

REUSE OF DOCUMENTS:  
This document, and the designs incorporated herein, are the property of Harris Miniature Golf Courses, Inc. and are not to be used in whole or in part for construction of this, or any other project without written authorization of Harris Miniature Golf Courses, Inc.

PROJECT: Proposed Miniature Golf Middletown, RI	
DRAWN BY: J. Onyszczak	DATE: 08/31/21
CHECKED BY: G. Lynn	JOB #: 21-85-2
DETAIL SHEET #2	SHEET: 7 OF 10
REVISIONS:	
DATE PRINTED: 09/01/22	

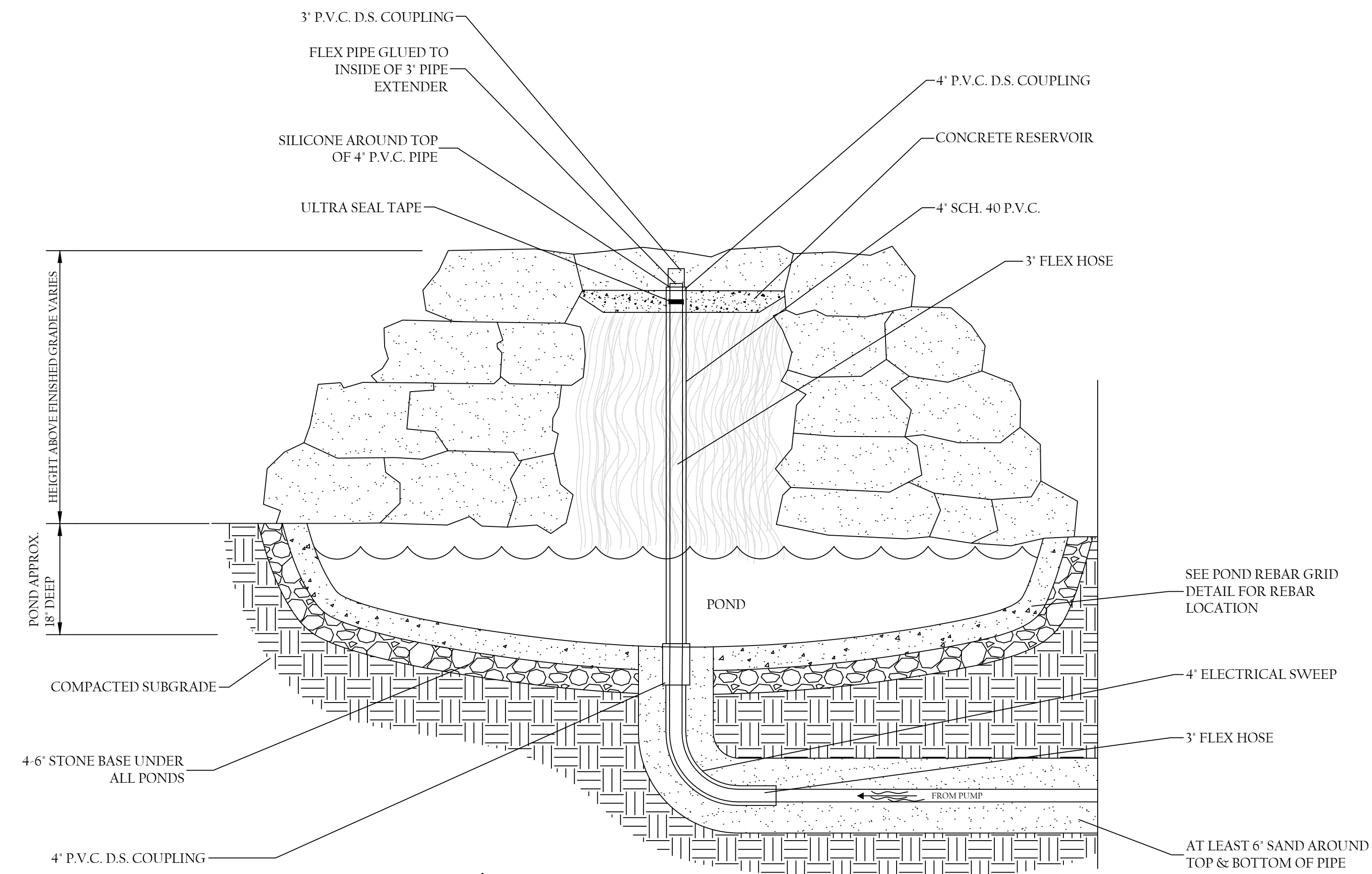

**1**  
**8** CUSTOM BOULDER WATERFALL ELEVATION  
NOT TO SCALE

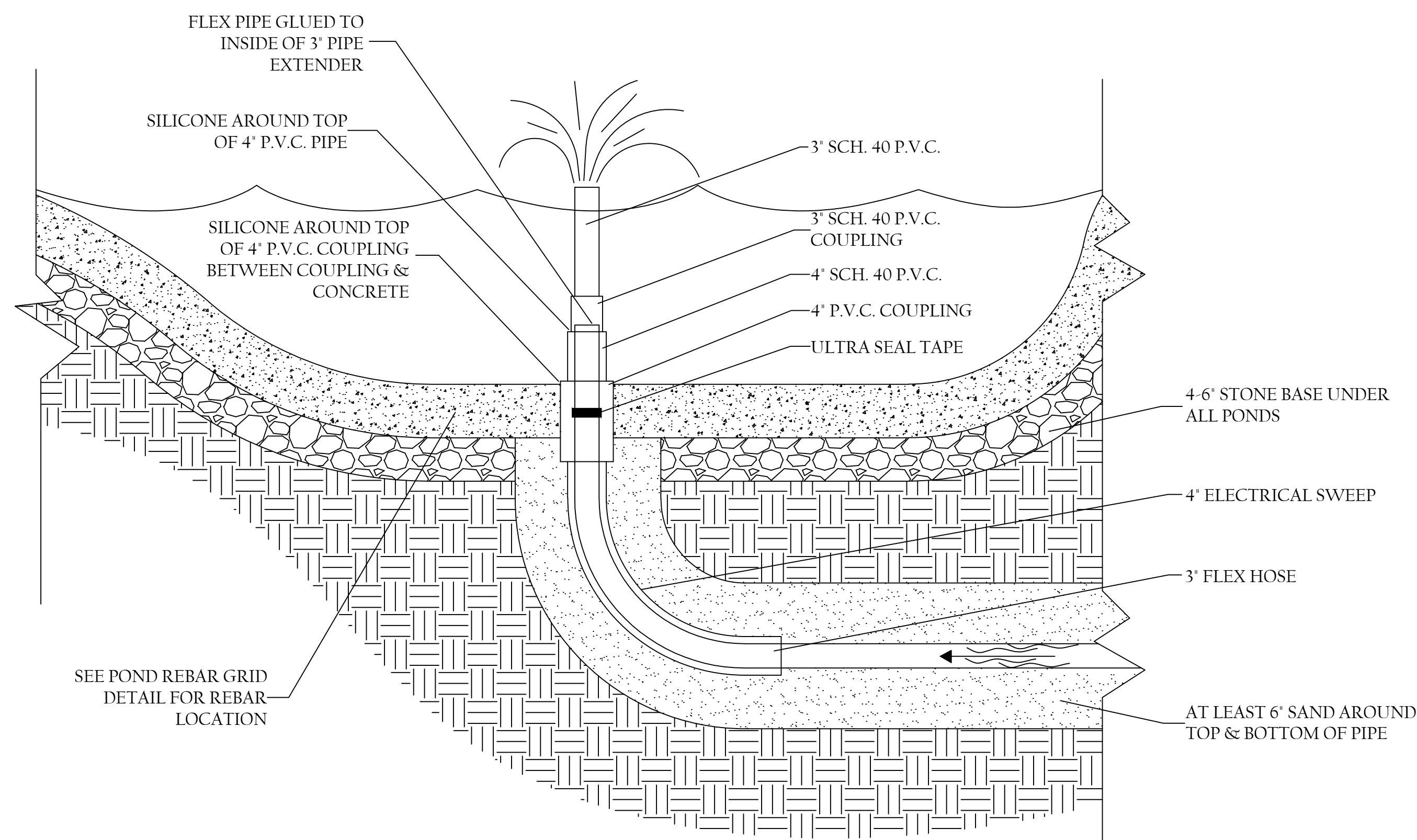

**J**  
**8** UPPER POND SECTION DETAIL  
NOT TO SCALE

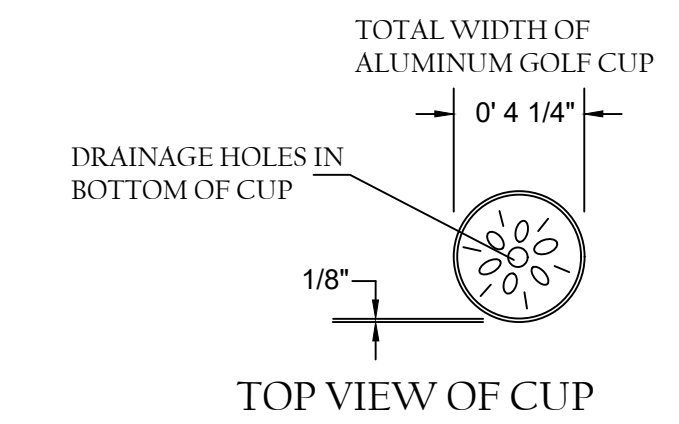
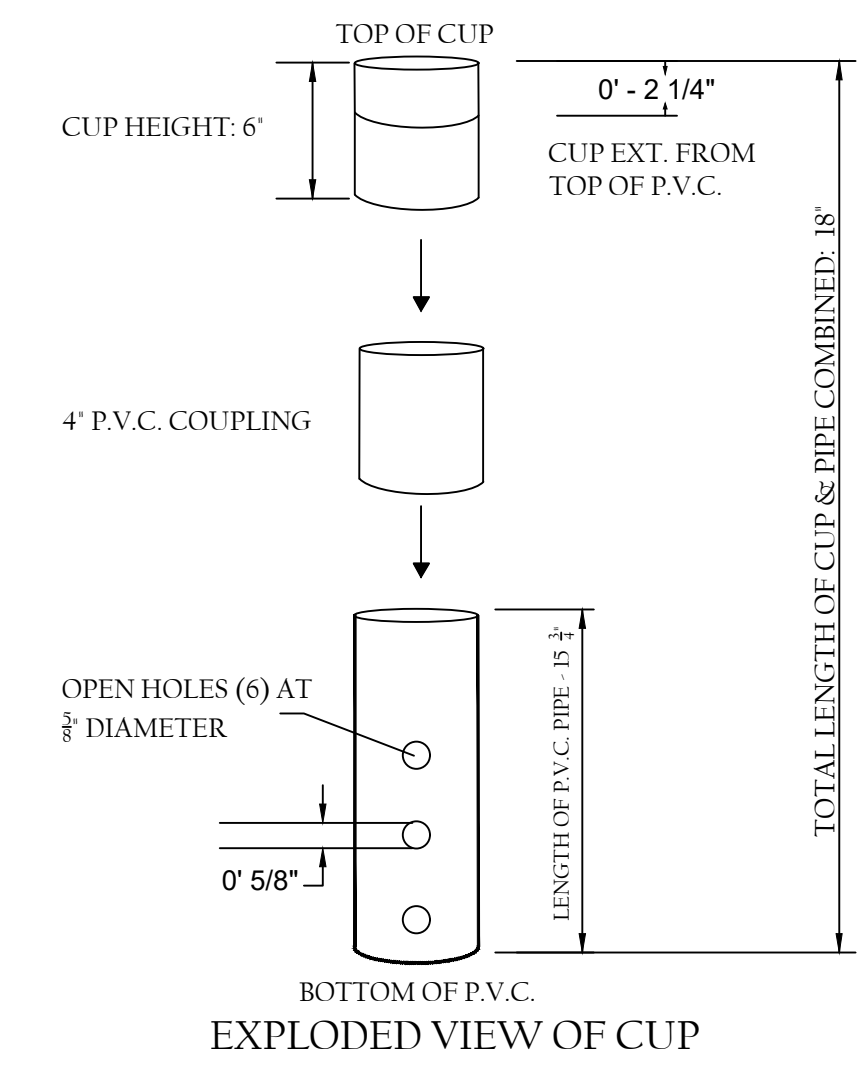

NOTES: HOLE DRAINAGE  
-GOLF CUP ASSEMBLY WILL DRAIN THE MAJORITY OF THE 12" WIDE PUTTING GREEN  
-SPACING IN BRICKS WILL ALLOW FOR SIDE DRAINAGE

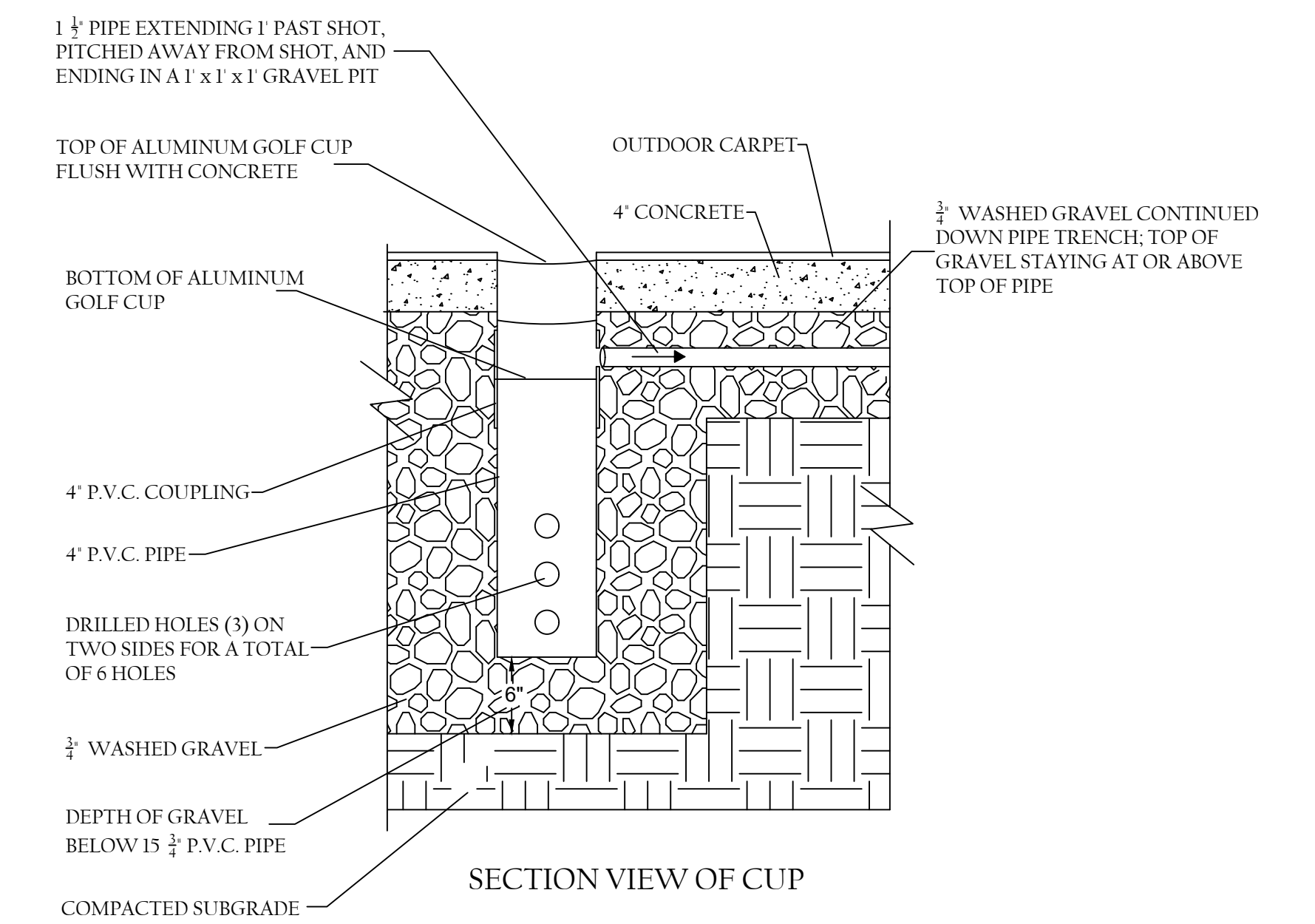

**K**  
**8** CUP ASSEMBLY & DRAINAGE  
NOT TO SCALE



NOTES:  
- ALL CONCRETE ON SITE SHALL BE A FIBER MESH BASED CONCRETE WITH A 3500 P.S.I. RATING

Handicap accessible portions of the course(s) are designed in accordance with ADAAG (Americans with Disabilities Act Accessibility Guidelines) Chapter 10 Section 1007.

REUSE OF DOCUMENTS:  
This document, and the designs incorporated herein, are the property of Harris Miniature Golf Courses, Inc. and are not to be used in whole or in part for construction of this, or any other project without written authorization of Harris Miniature Golf Courses, Inc.

PROJECT: Proposed  
Miniature Golf  
Middletown, RI

DRAWN BY: J. Onyszczak DATE: 08/31/21

CHECKED BY: G. Lynn JOB #: 21-85-2

DETAIL SHEET #3 SHEET: 8 OF 10

REVISIONS:	

DATE PRINTED: 09/01/22

