

DAN GORDON  
LANDSCAPE ARCHITECTS  
267 WASHINGTON ST., STE 6  
WELLESLEY MA 02481  
T: 781 237 5751  
17 WINTER STREET, UNIT 27  
EDGARTOWN, MA 02519

ISSUED:  
FOR PERMIT

REVISED:  
1. 7/21/2021  
2.  
3.



DATE: JULY 15, 2021  
DRAWN BY: DD, JL & CH  
SCALE: 1" = 10'-0"

LANDSCAPE  
PLAN

LP-1

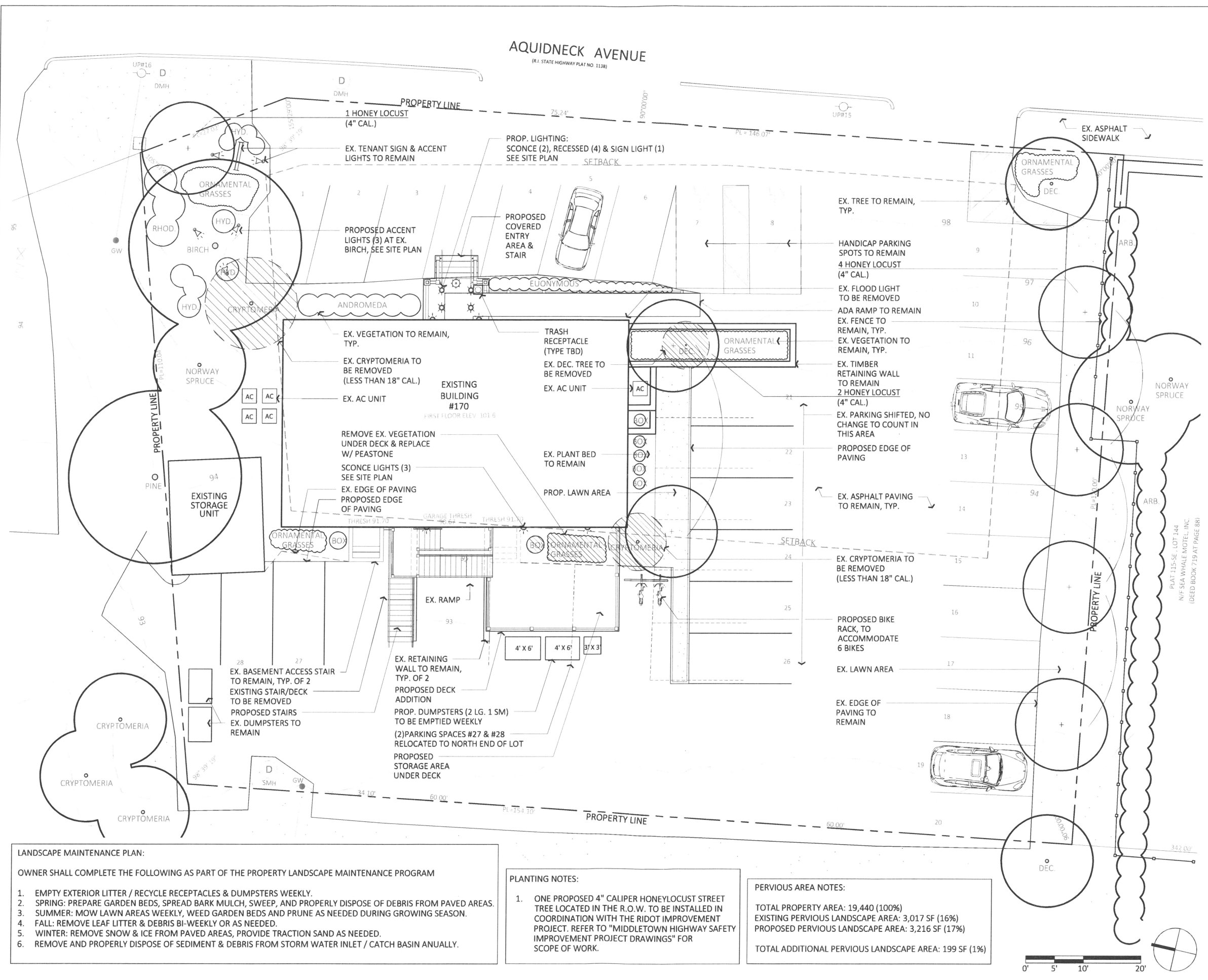

- LANDSCAPE MAINTENANCE PLAN:**
- OWNER SHALL COMPLETE THE FOLLOWING AS PART OF THE PROPERTY LANDSCAPE MAINTENANCE PROGRAM
- EMPTY EXTERIOR LITTER / RECYCLE RECEPTACLES & DUMPSTERS WEEKLY.
  - SPRING: PREPARE GARDEN BEDS, SPREAD BARK MULCH, SWEEP, AND PROPERLY DISPOSE OF DEBRIS FROM PAVED AREAS.
  - SUMMER: MOW LAWN AREAS WEEKLY, WEED GARDEN BEDS AND PRUNE AS NEEDED DURING GROWING SEASON.
  - FALL: REMOVE LEAF LITTER & DEBRIS BI-WEEKLY OR AS NEEDED.
  - WINTER: REMOVE SNOW & ICE FROM PAVED AREAS, PROVIDE TRACTION SAND AS NEEDED.
  - REMOVE AND PROPERLY DISPOSE OF SEDIMENT & DEBRIS FROM STORM WATER INLET / CATCH BASIN ANNUALLY.

- PLANTING NOTES:**
- ONE PROPOSED 4" CALIBER HONEYLOCUST STREET TREE LOCATED IN THE R.O.W. TO BE INSTALLED IN COORDINATION WITH THE RIDOT IMPROVEMENT PROJECT. REFER TO "MIDDLETOWN HIGHWAY SAFETY IMPROVEMENT PROJECT DRAWINGS" FOR SCOPE OF WORK.

- PERVIOUS AREA NOTES:**
- TOTAL PROPERTY AREA: 19,440 (100%)  
EXISTING PERVIOUS LANDSCAPE AREA: 3,017 SF (16%)  
PROPOSED PERVIOUS LANDSCAPE AREA: 3,216 SF (17%)  
TOTAL ADDITIONAL PERVIOUS LANDSCAPE AREA: 199 SF (1%)

